

SILVERTHIN SB050XP0**5 in Open Type X Thin Section Bearing****Specifications**

Bore (B)	5.000 in
Outside Diameter (D)	5.625 in
Width	5/16"
Land Diameter (L ₁)	5.231 in
Land Diameter (L ₂)	5.393 in
Approximate Weight	0.38 lbs
Separator	Brass; snapover separator
Precision Class	ABEC Class 1
Bearing Type	4-Point Contact (Type X)
Seals, Shields	None (Open)
Unit System	Inch

Load Capacities

Static Radial Load	2,150 lbf
Dynamic Radial Load	1,235 lbf
Static Thrust Load	5,380 lbf
Dynamic Thrust Load	1,980 lbf
Static Moment Load	5,720 in-lbs
Dynamic Moment Load	2,465 in-lbs

Interchange

Silverthin	SB050XP0	Kaydon	KB050XP0	Kaydon	KB050XP0	INA	CSXB050
SKF	FPXB500	FAG	L18RA500	NSK	NBX12707	NTN	KXB050
SSB	RB050XP0	RBC	KB050XP0*RBC				

Brass; snapover separator

5/32" balls

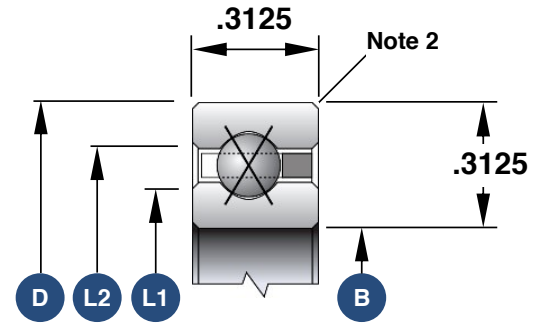

1. Load capacities are not additive
2. The maximum shaft or housing fillet radius that the bearing corners will clear for this series is 0.040"
3. Race Width Tolerance: +0.000 -0.005"

Also Available

Open Angular Contact	SB050AR0
Open Radial Contact	SB050CP0
Sealed Radial Contact	JSB050CP0
Sealed 4-Point Contact	JSB050XP0
Open Duplexed (Back-to-Back)	SB050BR0
Open Duplexed (Face-to-Face)	SB050FR0