

SILVERTHIN SB055ARO**5.5 in Open Type A Thin Section Bearing****Specifications**

Bore (B)	5.500 in
Outside Diameter (D)	6.125 in
Width	5/16"
Land Diameter (L ₁)	5.731 in
Land Diameter (L ₂)	5.893 in
Land Diameter (L ₃)	5.958 in
Approximate Weight	0.41 lbs
Separator	Brass; one piece pocket separator
Precision Class	ABEC Class 1
Bearing Type	Angular Contact (Type A)
Seals, Shields	None (Open)
Unit System	Inch

Load Capacities

Static Radial Load	2,740 lbf
Dynamic Radial Load	1,035 lbf
Static Thrust Load	7,920 lbf
Dynamic Thrust Load	2,560 lbf

Interchange

Silverthin	SB055ARO	Kaydon	KB055ARO	Kaydon	KB055ARO	INA	CSEB055
SKF	FPAB508	FAG	L15RA508	NSK	NBA13907	NTN	KYB055
SSB	RB055ARO	RBC	KB055ARO*RBC				

Brass; one piece pocket separator

5/32" balls

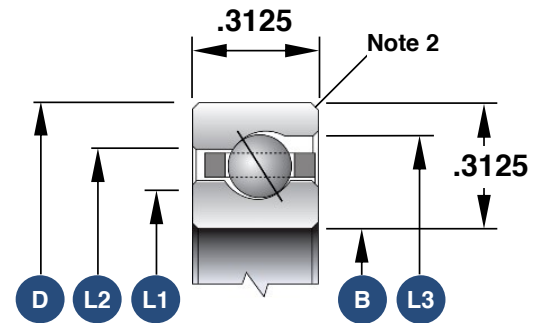

1. Load capacities are not additive
2. The maximum shaft or housing fillet radius that the bearing corners will clear for this series is 0.040"
3. Race Width Tolerance: +0.000 -0.005"

Also Available

Open Radial Contact	SB055CP0
Open 4-Point Contact	SB055XP0
Sealed Radial Contact	JSB055CP0
Sealed 4-Point Contact	JSB055XP0
Open Duplexed (Back-to-Back)	SB055BR0
Open Duplexed (Face-to-Face)	SB055FR0