

SILVERTHIN SB055CP0**5.5 in Open Type C Thin Section Bearing****Specifications**

Bore (B)	5.500 in
Outside Diameter (D)	6.125 in
Width	5/16"
Land Diameter (L ₁)	5.731 in
Land Diameter (L ₂)	5.893 in
Approximate Weight	0.41 lbs
Separator	Brass; snapover separator
Precision Class	ABEC Class 1
Bearing Type	Radial Contact (Type C)
Seals, Shields	None (Open)
Unit System	Inch

Load Capacities

Static Radial Load	2,360 lbf
Dynamic Radial Load	985 lbf

Interchange

Silverthin	SB055CP0	Kaydon	KB055CP0	Kaydon	KB055CP0	INA	CSCB055
SKF	FPCB508	FAG	L10RA508	NSK	NBC13907	NTN	KRB055
SSB	RB055CP0	RBC	KB055CP0*RBC				

Brass; snapover separator

5/32" balls

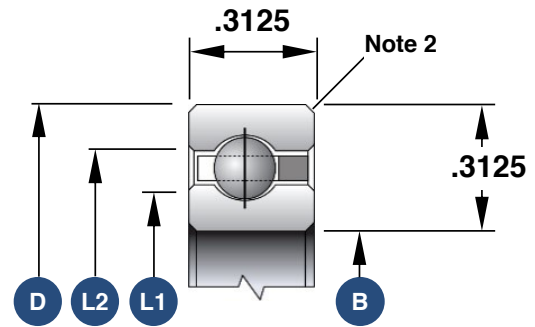

1. Load capacities are not additive
2. The maximum shaft or housing fillet radius that the bearing corners will clear for this series is 0.040"
3. Race Width Tolerance: +0.000 -0.005"

Also Available

Open Angular Contact	SB055AR0
Open 4-Point Contact	SB055XP0
Sealed Radial Contact	JSB055CP0
Sealed 4-Point Contact	JSB055XP0
Open Duplexed (Back-to-Back)	SB055BR0
Open Duplexed (Face-to-Face)	SB055FR0