

SILVERTHIN SB055XP0**5.5 in Open Type X Thin Section Bearing****Specifications**

Bore (B)	5.500 in
Outside Diameter (D)	6.125 in
Width	5/16"
Land Diameter (L ₁)	5.731 in
Land Diameter (L ₂)	5.893 in
Approximate Weight	0.41 lbs
Separator	Brass; snapover separator
Precision Class	ABEC Class 1
Bearing Type	4-Point Contact (Type X)
Seals, Shields	None (Open)
Unit System	Inch

Load Capacities

Static Radial Load	2,360 lbf
Dynamic Radial Load	1,305 lbf
Static Thrust Load	5,890 lbf
Dynamic Thrust Load	2,100 lbf
Static Moment Load	6,850 in-lbs
Dynamic Moment Load	2,845 in-lbs

Interchange

Silverthin	SB055XP0	Kaydon	KB055XP0	Kaydon	KB055XP0	INA	CSXB055
SKF	FPXB508	FAG	L18RA508	NSK	NBX13907	NTN	KXB055
SSB	RB055XP0	RBC	KB055XP0*RBC				

Brass; snapover separator

5/32" balls

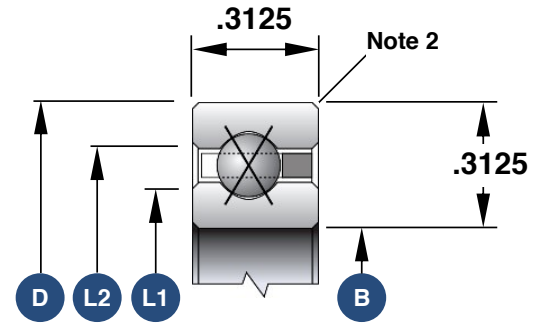

1. Load capacities are not additive
2. The maximum shaft or housing fillet radius that the bearing corners will clear for this series is 0.040"
3. Race Width Tolerance: +0.000 -0.005"

Also Available

Open Angular Contact	SB055AR0
Open Radial Contact	SB055CP0
Sealed Radial Contact	JSB055CP0
Sealed 4-Point Contact	JSB055XP0
Open Duplexed (Back-to-Back)	SB055BR0
Open Duplexed (Face-to-Face)	SB055FR0