

**SILVERTHIN SB060AR0****6 in Open Type A Thin Section Bearing****Specifications**

Bore (B)	6.000 in
Outside Diameter (D)	6.625 in
Width	5/16"
Land Diameter (L <sub>1</sub> )	6.231 in
Land Diameter (L <sub>2</sub> )	6.393 in
Land Diameter (L <sub>3</sub> )	6.458 in
Approximate Weight	0.44 lbs
Separator	Brass; one piece pocket separator
Precision Class	ABEC Class 1
Bearing Type	Angular Contact (Type A)
Seals, Shields	None (Open)
Unit System	Inch

**Load Capacities**

Static Radial Load	2,990 lbf
Dynamic Radial Load	1,090 lbf
Static Thrust Load	8,630 lbf
Dynamic Thrust Load	2,710 lbf

**Interchange**

Silverthin	<b>SB060AR0</b>	Kaydon	<b>KB060AR0</b>	Kaydon	<b>KB060AR0</b>	INA	<b>CSEB060</b>
SKF	<b>FPAB600</b>	FAG	<b>L15RA600</b>	NSK	<b>NBA15207</b>	NTN	<b>KYB060</b>
SSB	<b>RB060AR0</b>	RBC	<b>KB060AR0*RBC</b>				

**Brass; one piece pocket separator**

5/32" balls

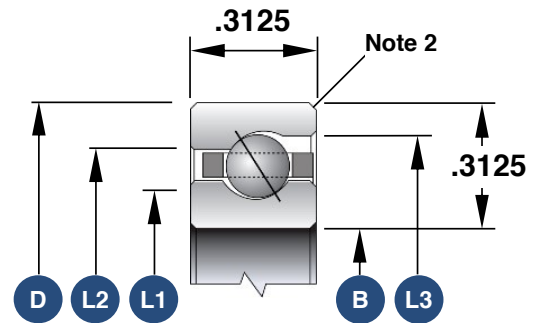

1. Load capacities are not additive
2. The maximum shaft or housing fillet radius that the bearing corners will clear for this series is 0.040"
3. Race Width Tolerance: +0.000 -0.005"

**Also Available**

Open Radial Contact	<b>SB060CP0</b>
Open 4-Point Contact	<b>SB060XP0</b>
Sealed Radial Contact	<b>JSB060CP0</b>
Sealed 4-Point Contact	<b>JSB060XP0</b>
Open Duplexed (Back-to-Back)	<b>SB060BR0</b>
Open Duplexed (Face-to-Face)	<b>SB060FR0</b>