

SILVERTHIN SB060XP0**6 in Open Type X Thin Section Bearing****Specifications**

| | |
|---------------------------------|---------------------------|
| Bore (B) | 6.000 in |
| Outside Diameter (D) | 6.625 in |
| Width | 5/16" |
| Land Diameter (L ₁) | 6.231 in |
| Land Diameter (L ₂) | 6.393 in |
| Approximate Weight | 0.44 lbs |
| Separator | Brass; snapover separator |
| Precision Class | ABEC Class 1 |
| Bearing Type | 4-Point Contact (Type X) |
| Seals, Shields | None (Open) |
| Unit System | Inch |

Load Capacities

| | |
|---------------------|--------------|
| Static Radial Load | 2,560 lbf |
| Dynamic Radial Load | 1,370 lbf |
| Static Thrust Load | 6,400 lbf |
| Dynamic Thrust Load | 2,220 lbf |
| Static Moment Load | 8,080 in-lbs |
| Dynamic Moment Load | 3,245 in-lbs |

Interchange

| | | | | | | | |
|------------|-----------------|--------|---------------------|--------|-----------------|-----|----------------|
| Silverthin | SB060XP0 | Kaydon | KB060XP0 | Kaydon | KB060XP0 | INA | CSXB060 |
| SKF | FPXB600 | FAG | L18RA600 | NSK | NBX15207 | NTN | KXB060 |
| SSB | RB060XP0 | RBC | KB060XP0*RBC | | | | |

Brass; snapover separator

5/32" balls

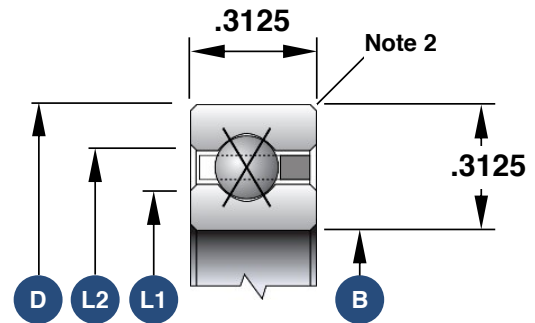

1. Load capacities are not additive
2. The maximum shaft or housing fillet radius that the bearing corners will clear for this series is 0.040"
3. Race Width Tolerance: +0.000 -0.005"

Also Available

| | |
|------------------------------|------------------|
| Open Angular Contact | SB060AR0 |
| Open Radial Contact | SB060CP0 |
| Sealed Radial Contact | JSB060CP0 |
| Sealed 4-Point Contact | JSB060XP0 |
| Open Duplexed (Back-to-Back) | SB060BR0 |
| Open Duplexed (Face-to-Face) | SB060FR0 |