

SILVERTHIN SB065ARO**6.5 in Open Type A Thin Section Bearing****Specifications**

Bore (B)	6.500 in
Outside Diameter (D)	7.125 in
Width	5/16"
Land Diameter (L ₁)	6.731 in
Land Diameter (L ₂)	6.893 in
Land Diameter (L ₃)	6.958 in
Approximate Weight	0.47 lbs
Separator	Brass; one piece pocket separator
Precision Class	ABEC Class 1
Bearing Type	Angular Contact (Type A)
Seals, Shields	None (Open)
Unit System	Inch

Load Capacities

Static Radial Load	3,200 lbf
Dynamic Radial Load	1,130 lbf
Static Thrust Load	9,240 lbf
Dynamic Thrust Load	2,840 lbf

Interchange

Silverthin	SB065ARO	Kaydon	KB065ARO	Kaydon	KB065ARO	INA	CSEB065
SKF	FPAB608	FAG	L15RA608	NSK	NBA16507	NTN	KYB065
SSB	RB065ARO	RBC	KB065ARO*RBC				

Brass; one piece pocket separator

5/32" balls

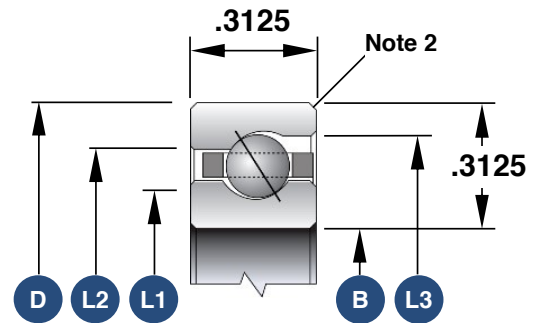

1. Load capacities are not additive
2. The maximum shaft or housing fillet radius that the bearing corners will clear for this series is 0.040"
3. Race Width Tolerance: +0.000 -0.005"

Also Available

Open Radial Contact	SB065CP0
Open 4-Point Contact	SB065XP0
Sealed Radial Contact	JSB065CP0
Sealed 4-Point Contact	JSB065XP0
Open Duplexed (Back-to-Back)	SB065BR0
Open Duplexed (Face-to-Face)	SB065FR0