

**SILVERTHIN SB065CP0****6.5 in Open Type C Thin Section Bearing****Specifications**

Bore (B)	6.500 in
Outside Diameter (D)	7.125 in
Width	5/16"
Land Diameter (L <sub>1</sub> )	6.731 in
Land Diameter (L <sub>2</sub> )	6.893 in
Approximate Weight	0.47 lbs
Separator	Brass; snapover separator
Precision Class	ABEC Class 1
Bearing Type	Radial Contact (Type C)
Seals, Shields	None (Open)
Unit System	Inch

**Load Capacities**

Static Radial Load	2,760 lbf
Dynamic Radial Load	1,080 lbf

**Interchange**

Silverthin	<b>SB065CP0</b>	Kaydon	<b>KB065CP0</b>	Kaydon	<b>KB065CP0</b>	INA	<b>CSCB065</b>
SKF	<b>FPCB608</b>	FAG	<b>L10RA608</b>	NSK	<b>NBC16507</b>	NTN	<b>KRB065</b>
SSB	<b>RB065CP0</b>	RBC	<b>KB065CP0*RBC</b>				

**Brass; snapover separator**

5/32" balls

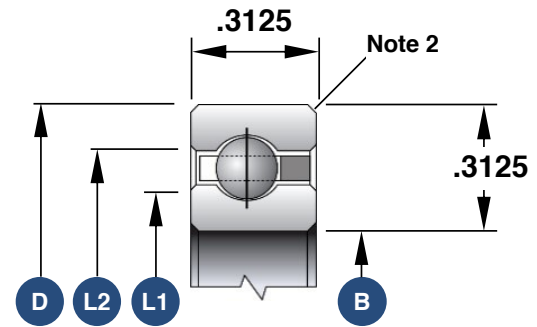

1. Load capacities are not additive
2. The maximum shaft or housing fillet radius that the bearing corners will clear for this series is 0.040"
3. Race Width Tolerance: +0.000 -0.005"

**Also Available**

Open Angular Contact	<b>SB065AR0</b>
Open 4-Point Contact	<b>SB065XP0</b>
Sealed Radial Contact	<b>JSB065CP0</b>
Sealed 4-Point Contact	<b>JSB065XP0</b>
Open Duplexed (Back-to-Back)	<b>SB065BR0</b>
Open Duplexed (Face-to-Face)	<b>SB065FR0</b>