

SILVERTHIN SB065XPO**6.5 in Open Type X Thin Section Bearing****Specifications**

Bore (B)	6.500 in
Outside Diameter (D)	7.125 in
Width	5/16"
Land Diameter (L ₁)	6.731 in
Land Diameter (L ₂)	6.893 in
Approximate Weight	0.47 lbs
Separator	Brass; snapover separator
Precision Class	ABEC Class 1
Bearing Type	4-Point Contact (Type X)
Seals, Shields	None (Open)
Unit System	Inch

Load Capacities

Static Radial Load	2,760 lbf
Dynamic Radial Load	1,435 lbf
Static Thrust Load	6,910 lbf
Dynamic Thrust Load	2,340 lbf
Static Moment Load	9,410 in-lbs
Dynamic Moment Load	3,670 in-lbs

Interchange

Silverthin	SB065XPO	Kaydon	KB065XPO	Kaydon	KB065XPO	INA	CSXB065
SKF	FPXB608	FAG	L18RA608	NSK	NBX16507	NTN	KXB065
SSB	RB065XPO	RBC	KB065XPO*RBC				

Brass; snapover separator

5/32" balls

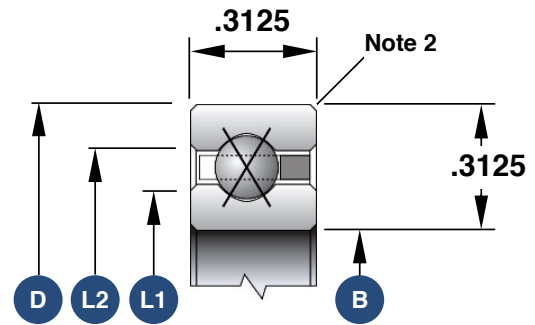

1. Load capacities are not additive
2. The maximum shaft or housing fillet radius that the bearing corners will clear for this series is 0.040"
3. Race Width Tolerance: +0.000 -0.005"

Also Available

Open Angular Contact	SB065AR0
Open Radial Contact	SB065CP0
Sealed Radial Contact	JSB065CP0
Sealed 4-Point Contact	JSB065XPO
Open Duplexed (Back-to-Back)	SB065BR0
Open Duplexed (Face-to-Face)	SB065FR0