

**SILVERTHIN SB070AR0****7 in Open Type A Thin Section Bearing****Specifications**

Bore (B)	7.000 in
Outside Diameter (D)	7.625 in
Width	5/16"
Land Diameter (L <sub>1</sub> )	7.231 in
Land Diameter (L <sub>2</sub> )	7.393 in
Land Diameter (L <sub>3</sub> )	7.456 in
Approximate Weight	0.50 lbs
Separator	Brass; one piece pocket separator
Precision Class	ABEC Class 1
Bearing Type	Angular Contact (Type A)
Seals, Shields	None (Open)
Unit System	Inch

**Load Capacities**

Static Radial Load	3,450 lbf
Dynamic Radial Load	1,185 lbf
Static Thrust Load	9,960 lbf
Dynamic Thrust Load	2,980 lbf

**Interchange**

Silverthin	<b>SB070AR0</b>	Kaydon	<b>KB070AR0</b>
SKF	<b>FPAB700</b>	FAG	<b>L15RA700</b>
SSB	<b>RB070AR0</b>	RBC	<b>KB070AR0*RBC</b>

**Brass; one piece pocket separator**

5/32" balls

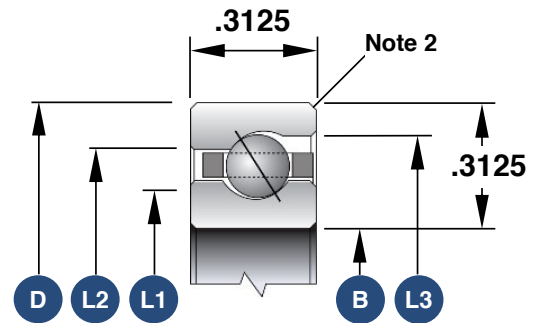

1. Load capacities are not additive
2. The maximum shaft or housing fillet radius that the bearing corners will clear for this series is 0.040"
3. Race Width Tolerance: +0.000 -0.005"

**Also Available**

Open Radial Contact	<b>SB070CP0</b>
Open 4-Point Contact	<b>SB070XP0</b>
Open Duplexed (Back-to-Back)	<b>SB070BR0</b>
Open Duplexed (Face-to-Face)	<b>SB070FR0</b>