

**SILVERTHIN SB070CP0****7 in Open Type C Thin Section Bearing****Specifications**

Bore (B)	7.000 in
Outside Diameter (D)	7.625 in
Width	5/16"
Land Diameter (L <sub>1</sub> )	7.231 in
Land Diameter (L <sub>2</sub> )	7.393 in
Approximate Weight	0.50 lbs
Separator	Brass; snapover separator
Precision Class	ABEC Class 1
Bearing Type	Radial Contact (Type C)
Seals, Shields	None (Open)
Unit System	Inch

**Load Capacities**

Static Radial Load	2,970 lbf
Dynamic Radial Load	1,130 lbf

**Interchange**

Silverthin	<a href="#">SB070CP0</a>	Kaydon	<a href="#">KB070CP0</a>	Kaydon	<a href="#">KB070CP0</a>	INA	<a href="#">CSCB070</a>
SKF	<a href="#">FPCB700</a>	FAG	<a href="#">L10RA700</a>	NSK	<a href="#">NBC17707</a>	NTN	<a href="#">KRB070</a>
SSB	<a href="#">RB070CP0</a>	RBC	<a href="#">KB070CP0*RBC</a>				

**Brass; snapover separator**

5/32" balls

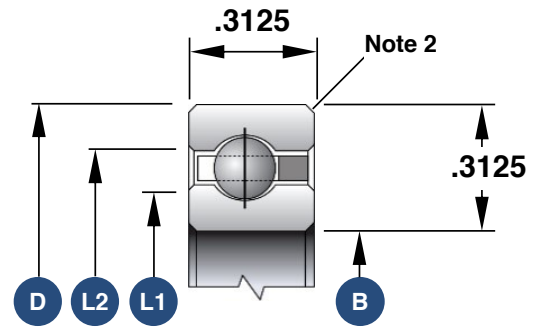

1. Load capacities are not additive
2. The maximum shaft or housing fillet radius that the bearing corners will clear for this series is 0.040"
3. Race Width Tolerance: +0.000 -0.005"

**Also Available**

Open Angular Contact	<a href="#">SB070AR0</a>
Open 4-Point Contact	<a href="#">SB070XP0</a>
Open Duplexed (Back-to-Back)	<a href="#">SB070BR0</a>
Open Duplexed (Face-to-Face)	<a href="#">SB070FR0</a>