

SILVERTHIN SB075ARO**7.5 in Open Type A Thin Section Bearing****Specifications**

Bore (B)	7.500 in
Outside Diameter (D)	8.125 in
Width	5/16"
Land Diameter (L ₁)	7.731 in
Land Diameter (L ₂)	7.893 in
Land Diameter (L ₃)	7.955 in
Approximate Weight	0.53 lbs
Separator	Brass; one piece pocket separator
Precision Class	ABEC Class 1
Bearing Type	Angular Contact (Type A)
Seals, Shields	None (Open)
Unit System	Inch

Load Capacities

Static Radial Load	3,700 lbf
Dynamic Radial Load	1,235 lbf
Static Thrust Load	10,670 lbf
Dynamic Thrust Load	3,120 lbf

Interchange

Silverthin	SB075ARO	Kaydon	KB075ARO
SKF	FPAB708	FAG	L15RA708
SSB	RB075ARO	RBC	KB075ARO*RBC

Brass; one piece pocket separator

5/32" balls

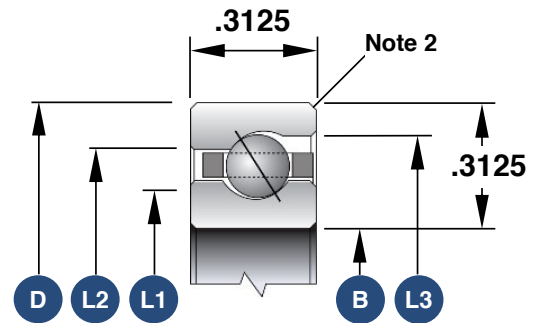

1. Load capacities are not additive
2. The maximum shaft or housing fillet radius that the bearing corners will clear for this series is 0.040"
3. Race Width Tolerance: +0.000 -0.005"

Also Available

Open Radial Contact	SB075CP0
Open 4-Point Contact	SB075XP0
Open Duplexed (Back-to-Back)	SB075BR0
Open Duplexed (Face-to-Face)	SB075FR0