

SILVERTHIN SB075CP0**7.5 in Open Type C Thin Section Bearing****Specifications**

Bore (B)	7.500 in
Outside Diameter (D)	8.125 in
Width	5/16"
Land Diameter (L ₁)	7.731 in
Land Diameter (L ₂)	7.893 in
Approximate Weight	0.53 lbs
Separator	Brass; snapover separator
Precision Class	ABEC Class 1
Bearing Type	Radial Contact (Type C)
Seals, Shields	None (Open)
Unit System	Inch

Load Capacities

Static Radial Load	3,170 lbf
Dynamic Radial Load	1,175 lbf

Interchange

Silverthin	SB075CP0	Kaydon	KB075CP0	Kaydon	KB075CP0	INA	CSCB075
SKF	FPCB708	FAG	L10RA708	NSK	NBC19007	NTN	KRB075
SSB	RB075CP0	RBC	KB075CP0*RBC				

Brass; snapover separator

5/32" balls

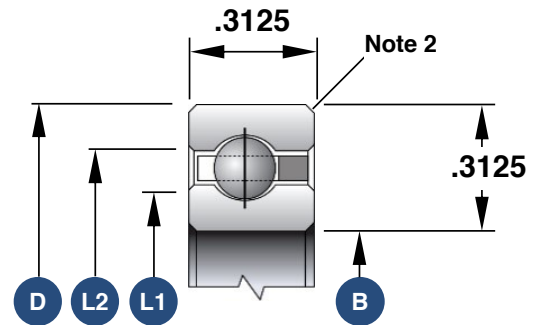

1. Load capacities are not additive
2. The maximum shaft or housing fillet radius that the bearing corners will clear for this series is 0.040"
3. Race Width Tolerance: +0.000 -0.005"

Also Available

Open Angular Contact	SB075AR0
Open 4-Point Contact	SB075XP0
Open Duplexed (Back-to-Back)	SB075BR0
Open Duplexed (Face-to-Face)	SB075FR0