

**SILVERTHIN SB075XP0****7.5 in Open Type X Thin Section Bearing****Specifications**

Bore (B)	7.500 in
Outside Diameter (D)	8.125 in
Width	5/16"
Land Diameter (L <sub>1</sub> )	7.731 in
Land Diameter (L <sub>2</sub> )	7.893 in
Approximate Weight	0.53 lbs
Separator	Brass; snapover separator
Precision Class	ABEC Class 1
Bearing Type	4-Point Contact (Type X)
Seals, Shields	None (Open)
Unit System	Inch

**Load Capacities**

Static Radial Load	3,170 lbf
Dynamic Radial Load	1,560 lbf
Static Thrust Load	7,920 lbf
Dynamic Thrust Load	2,560 lbf
Static Moment Load	12,380 in-lbs
Dynamic Moment Load	4,570 in-lbs

**Interchange**

Silverthin	<b>SB075XP0</b>	Kaydon	<b>KB075XP0</b>	Kaydon	<b>KB075XP0</b>	INA	<b>CSXB075</b>
SKF	<b>FPXB708</b>	FAG	<b>L18RA708</b>	NSK	<b>NBX19007</b>	NTN	<b>KXB075</b>
SSB	<b>RB075XP0</b>	RBC	<b>KB075XP0*RBC</b>				

**Brass; snapover separator**

5/32" balls

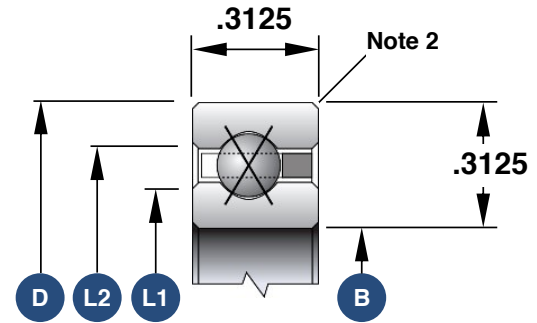

1. Load capacities are not additive
2. The maximum shaft or housing fillet radius that the bearing corners will clear for this series is 0.040"
3. Race Width Tolerance: +0.000 -0.005"

**Also Available**

Open Angular Contact	<b>SB075AR0</b>
Open Radial Contact	<b>SB075CP0</b>
Open Duplexed (Back-to-Back)	<b>SB075BR0</b>
Open Duplexed (Face-to-Face)	<b>SB075FR0</b>