

SILVERTHIN SB080AR0**8 in Open Type A Thin Section Bearing****Specifications**

Bore (B)	8.000 in
Outside Diameter (D)	8.625 in
Width	5/16"
Land Diameter (L ₁)	8.231 in
Land Diameter (L ₂)	8.393 in
Land Diameter (L ₃)	8.453 in
Approximate Weight	0.57 lbs
Separator	Brass; one piece pocket separator
Precision Class	ABEC Class 1
Bearing Type	Angular Contact (Type A)
Seals, Shields	None (Open)
Unit System	Inch

Load Capacities

Static Radial Load	3,940 lbf
Dynamic Radial Load	1,285 lbf
Static Thrust Load	11,380 lbf
Dynamic Thrust Load	3,260 lbf

Interchange

Silverthin	SB080AR0	Kaydon	KB080AR0
SKF	FPAB800	FAG	L15RA800
SSB	RB080AR0	RBC	KB080AR0*RBC

Brass; one piece pocket separator

5/32" balls

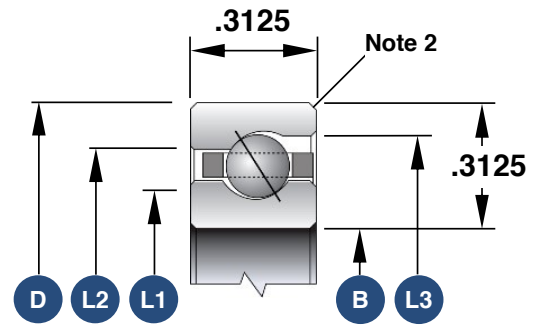

1. Load capacities are not additive
2. The maximum shaft or housing fillet radius that the bearing corners will clear for this series is 0.040"
3. Race Width Tolerance: +0.000 -0.005"

Also Available

Open Radial Contact	SB080CP0
Open 4-Point Contact	SB080XP0
Open Duplexed (Back-to-Back)	SB080BR0
Open Duplexed (Face-to-Face)	SB080FR0

Kaydon	KB080AR0	INA	CSEB080
NSK	NBA20307	NTN	KYB080