

SILVERTHIN SB080XP0**8 in Open Type X Thin Section Bearing****Specifications**

Bore (B)	8.000 in
Outside Diameter (D)	8.625 in
Width	5/16"
Land Diameter (L ₁)	8.231 in
Land Diameter (L ₂)	8.393 in
Approximate Weight	0.57 lbs
Separator	Brass; snapover separator
Precision Class	ABEC Class 1
Bearing Type	4-Point Contact (Type X)
Seals, Shields	None (Open)
Unit System	Inch

Load Capacities

Static Radial Load	3,370 lbf
Dynamic Radial Load	1,620 lbf
Static Thrust Load	8,430 lbf
Dynamic Thrust Load	2,670 lbf
Static Moment Load	14,020 in-lbs
Dynamic Moment Load	5,045 in-lbs

Interchange

Silverthin	SB080XP0	Kaydon	KB080XP0	Kaydon	KB080XP0	INA	CSXB080
SKF	FPXB800	FAG	L18RA800	NSK	NBX20307	NTN	KXB080
SSB	RB080XP0	RBC	KB080XP0*RBC				

Brass; snapover separator

5/32" balls

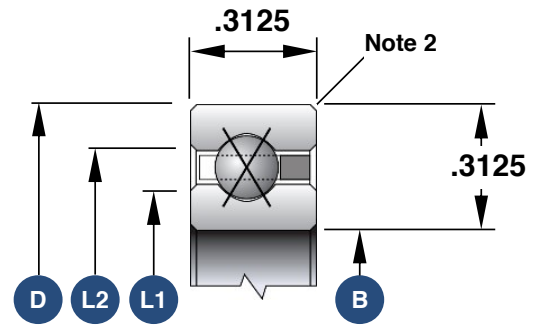

1. Load capacities are not additive
2. The maximum shaft or housing fillet radius that the bearing corners will clear for this series is 0.040"
3. Race Width Tolerance: +0.000 -0.005"

Also Available

Open Angular Contact	SB080AR0
Open Radial Contact	SB080CP0
Open Duplexed (Back-to-Back)	SB080BR0
Open Duplexed (Face-to-Face)	SB080FR0