

SILVERTHIN SB090AR0**9 in Open Type A Thin Section Bearing****Specifications**

Bore (B)	9.000 in
Outside Diameter (D)	9.625 in
Width	5/16"
Land Diameter (L ₁)	9.231 in
Land Diameter (L ₂)	9.393 in
Land Diameter (L ₃)	9.451 in
Approximate Weight	0.66 lbs
Separator	Brass; one piece pocket separator
Precision Class	ABEC Class 1
Bearing Type	Angular Contact (Type A)
Seals, Shields	None (Open)
Unit System	Inch

Load Capacities

Static Radial Load	4,400 lbf
Dynamic Radial Load	1,370 lbf
Static Thrust Load	12,700 lbf
Dynamic Thrust Load	3,510 lbf

Interchange

Silverthin	SB090AR0	Kaydon	KB090AR0
SKF	FPAB900	FAG	L15RA900
SSB	RB090AR0	RBC	KB090AR0*RBC

Brass; one piece pocket separator

5/32" balls

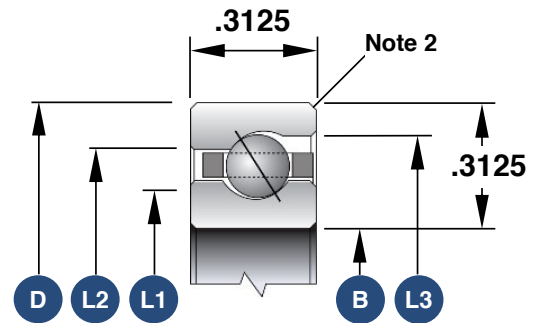

1. Load capacities are not additive
2. The maximum shaft or housing fillet radius that the bearing corners will clear for this series is 0.040"
3. Race Width Tolerance: +0.000 -0.005"

Also Available

Open Radial Contact	SB090CP0
Open 4-Point Contact	SB090XP0
Open Duplexed (Back-to-Back)	SB090BR0
Open Duplexed (Face-to-Face)	SB090FR0