

SILVERTHIN SB090XP0**9 in Open Type X Thin Section Bearing****Specifications**

Bore (B)	9.000 in
Outside Diameter (D)	9.625 in
Width	5/16"
Land Diameter (L ₁)	9.231 in
Land Diameter (L ₂)	9.393 in
Approximate Weight	0.66 lbs
Separator	Brass; snapover separator
Precision Class	ABEC Class 1
Bearing Type	4-Point Contact (Type X)
Seals, Shields	None (Open)
Unit System	Inch

Load Capacities

Static Radial Load	3,780 lbf
Dynamic Radial Load	1,730 lbf
Static Thrust Load	9,450 lbf
Dynamic Thrust Load	2,880 lbf
Static Moment Load	17,600 in-lbs
Dynamic Moment Load	6,050 in-lbs

Interchange

Silverthin	SB090XP0	Kaydon	KB090XP0	Kaydon	KB090XP0	INA	CSXB090
SKF	FPXB900	FAG	L18RA900	NSK	NBX22807	NTN	KXB090
SSB	RB090XP0	RBC	KB090XP0*RBC				

Brass; snapover separator

5/32" balls

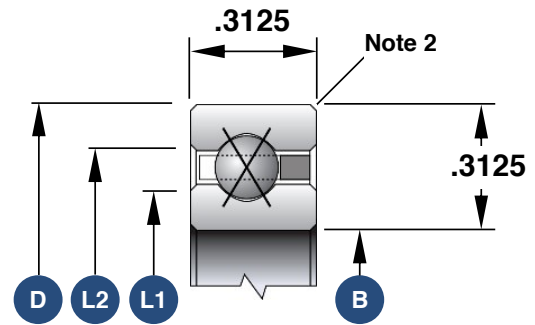

1. Load capacities are not additive
2. The maximum shaft or housing fillet radius that the bearing corners will clear for this series is 0.040"
3. Race Width Tolerance: +0.000 -0.005"

Also Available

Open Angular Contact	SB090AR0
Open Radial Contact	SB090CP0
Open Duplexed (Back-to-Back)	SB090BR0
Open Duplexed (Face-to-Face)	SB090FR0