

SILVERTHIN SB100AR0**10 in Open Type A Thin Section Bearing****Specifications**

Bore (B)	10.000 in
Outside Diameter (D)	10.625 in
Width	5/16"
Land Diameter (L ₁)	10.231 in
Land Diameter (L ₂)	10.393 in
Land Diameter (L ₃)	10.449 in
Approximate Weight	0.73 lbs
Separator	Brass; one piece pocket separator
Precision Class	ABEC Class 1
Bearing Type	Angular Contact (Type A)
Seals, Shields	None (Open)
Unit System	Inch

Load Capacities

Static Radial Load	4,890 lbf
Dynamic Radial Load	1,460 lbf
Static Thrust Load	14,120 lbf
Dynamic Thrust Load	3,760 lbf

Interchange

Silverthin	SB100AR0	Kaydon	KB100AR0
SKF	FPAB1000	FAG	L15RA1000
SSB	RB100AR0	RBC	KB100AR0*RBC

Brass; one piece pocket separator

5/32" balls

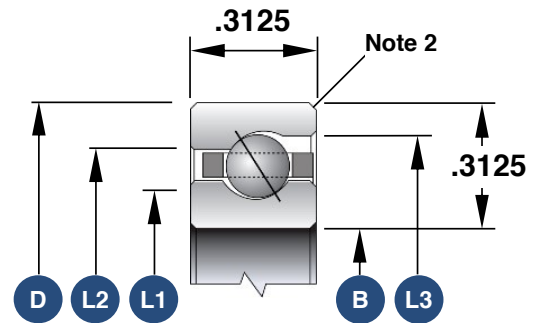

1. Load capacities are not additive
2. The maximum shaft or housing fillet radius that the bearing corners will clear for this series is 0.040"
3. Race Width Tolerance: +0.000 -0.005"

Also Available

Open Radial Contact	SB100CP0
Open 4-Point Contact	SB100XP0
Open Duplexed (Back-to-Back)	SB100BR0
Open Duplexed (Face-to-Face)	SB100FR0