

SILVERTHIN SB100CPO**10 in Open Type C Thin Section Bearing****Specifications**

Bore (B)	10.000 in
Outside Diameter (D)	10.625 in
Width	5/16"
Land Diameter (L ₁)	10.231 in
Land Diameter (L ₂)	10.393 in
Approximate Weight	0.73 lbs
Separator	Brass; snapover separator
Precision Class	ABEC Class 1
Bearing Type	Radial Contact (Type C)
Seals, Shields	None (Open)
Unit System	Inch

Load Capacities

Static Radial Load	4,190 lbf
Dynamic Radial Load	1,385 lbf

Interchange

Silverthin	SB100CPO	Kaydon	KB100CPO	Kaydon	KB100CPO	INA	CSCB100
SKF	FPCB1000	FAG	L10RA1000	NSK	NBC25407	NTN	KRB100
SSB	RB100CPO	RBC	KB100CPO*RBC				

Brass; snapover separator

5/32" balls

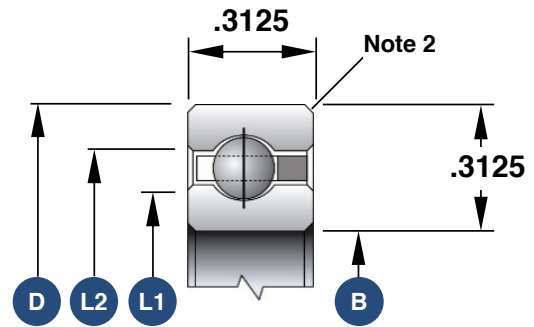

1. Load capacities are not additive
2. The maximum shaft or housing fillet radius that the bearing corners will clear for this series is 0.040"
3. Race Width Tolerance: +0.000 -0.005"

Also Available

Open Angular Contact	SB100ARO
Open 4-Point Contact	SB100XPO
Open Duplexed (Back-to-Back)	SB100BR0
Open Duplexed (Face-to-Face)	SB100FR0