

**SILVERTHIN SB100XPO****10 in Open Type X Thin Section Bearing****Specifications**

Bore (B)	10.000 in
Outside Diameter (D)	10.625 in
Width	5/16"
Land Diameter (L <sub>1</sub> )	10.231 in
Land Diameter (L <sub>2</sub> )	10.393 in
Approximate Weight	0.73 lbs
Separator	Brass; snapover separator
Precision Class	ABEC Class 1
Bearing Type	4-Point Contact (Type X)
Seals, Shields	None (Open)
Unit System	Inch

**Load Capacities**

Static Radial Load	4,190 lbf
Dynamic Radial Load	1,840 lbf
Static Thrust Load	10,460 lbf
Dynamic Thrust Load	3,080 lbf
Static Moment Load	21,580 in-lbs
Dynamic Moment Load	7,120 in-lbs

**Interchange**

Silverthin	<b>SB100XPO</b>	Kaydon	<b>KB100XPO</b>	Kaydon	<b>KB100XPO</b>	INA	<b>CSXB100</b>
SKF	<b>FPXB1000</b>	FAG	<b>L18RA1000</b>	NSK	<b>NBX25407</b>	NTN	<b>KXB100</b>
SSB	<b>RB100XPO</b>	RBC	<b>KB100XPO*RBC</b>				

**Brass; snapover separator**

5/32" balls

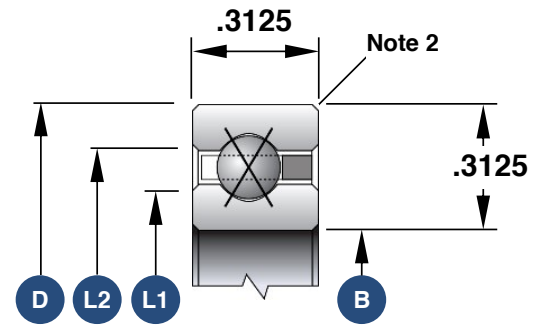

1. Load capacities are not additive
2. The maximum shaft or housing fillet radius that the bearing corners will clear for this series is 0.040"
3. Race Width Tolerance: +0.000 -0.005"

**Also Available**

Open Angular Contact	<b>SB100ARO</b>
Open Radial Contact	<b>SB100CPO</b>
Open Duplexed (Back-to-Back)	<b>SB100BR0</b>
Open Duplexed (Face-to-Face)	<b>SB100FR0</b>