

SILVERTHIN SB110AR0**11 in Open Type A Thin Section Bearing****Specifications**

Bore (B)	11.000 in
Outside Diameter (D)	11.625 in
Width	5/16"
Land Diameter (L ₁)	11.231 in
Land Diameter (L ₂)	11.393 in
Land Diameter (L ₃)	11.447 in
Approximate Weight	0.75 lbs
Separator	Brass; one piece pocket separator
Precision Class	ABEC Class 1
Bearing Type	Angular Contact (Type A)
Seals, Shields	None (Open)
Unit System	Inch

Load Capacities

Static Radial Load	5,350 lbf
Dynamic Radial Load	1,540 lbf
Static Thrust Load	15,440 lbf
Dynamic Thrust Load	4,000 lbf

Interchange

Silverthin	SB110AR0	Kaydon	KB110AR0
SKF	FPAB1100	FAG	L15RA1100
SSB	RB110AR0	RBC	KB110AR0*RBC

Brass; one piece pocket separator

5/32" balls

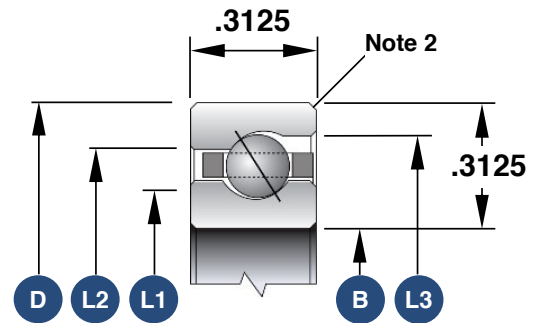

1. Load capacities are not additive
2. The maximum shaft or housing fillet radius that the bearing corners will clear for this series is 0.040"
3. Race Width Tolerance: +0.000 -0.005"

Also Available

Open Radial Contact	SB110CP0
Open 4-Point Contact	SB110XP0
Open Duplexed (Back-to-Back)	SB110BR0
Open Duplexed (Face-to-Face)	SB110FR0