

SILVERTHIN SB110CP0**11 in Open Type C Thin Section Bearing****Specifications**

Bore (B)	11.000 in
Outside Diameter (D)	11.625 in
Width	5/16"
Land Diameter (L ₁)	11.231 in
Land Diameter (L ₂)	11.393 in
Approximate Weight	0.75 lbs
Separator	Brass; snapover separator
Precision Class	ABEC Class 1
Bearing Type	Radial Contact (Type C)
Seals, Shields	None (Open)
Unit System	Inch

Load Capacities

Static Radial Load	4,590 lbf
Dynamic Radial Load	1,465 lbf

Interchange

Silverthin	SB110CP0	Kaydon	KB110CP0	Kaydon	KB110CP0	INA	CSCB110
SKF	FPCB1100	FAG	L10RA1100	NSK	NBC27907	NTN	KRB110
SSB	RB110CP0	RBC	KB110CP0*RBC				

Brass; snapover separator

5/32" balls

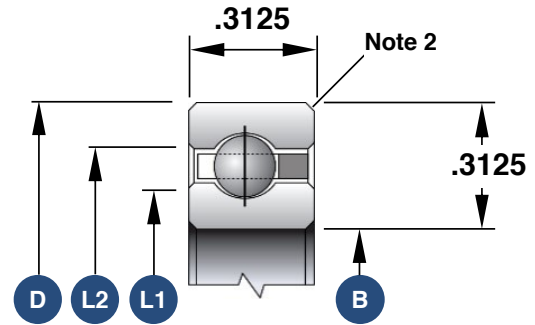

1. Load capacities are not additive
2. The maximum shaft or housing fillet radius that the bearing corners will clear for this series is 0.040"
3. Race Width Tolerance: +0.000 -0.005"

Also Available

Open Angular Contact	SB110AR0
Open 4-Point Contact	SB110XP0
Open Duplexed (Back-to-Back)	SB110BR0
Open Duplexed (Face-to-Face)	SB110FR0