

SILVERTHIN SB110XP0**11 in Open Type X Thin Section Bearing****Specifications**

Bore (B)	11.000 in
Outside Diameter (D)	11.625 in
Width	5/16"
Land Diameter (L ₁)	11.231 in
Land Diameter (L ₂)	11.393 in
Approximate Weight	0.75 lbs
Separator	Brass; snapover separator
Precision Class	ABEC Class 1
Bearing Type	4-Point Contact (Type X)
Seals, Shields	None (Open)
Unit System	Inch

Load Capacities

Static Radial Load	4,590 lbf
Dynamic Radial Load	1,945 lbf
Static Thrust Load	11,480 lbf
Dynamic Thrust Load	3,280 lbf
Static Moment Load	25,970 in-lbs
Dynamic Moment Load	8,255 in-lbs

Interchange

Silverthin	SB110XP0	Kaydon	KB110XP0	Kaydon	KB110XP0	INA	CSXB110
SKF	FPXB1100	FAG	L18RA1100	NSK	NBX27907	NTN	KXB110
SSB	RB110XP0	RBC	KB110XP0*RBC				

Brass; snapover separator

5/32" balls

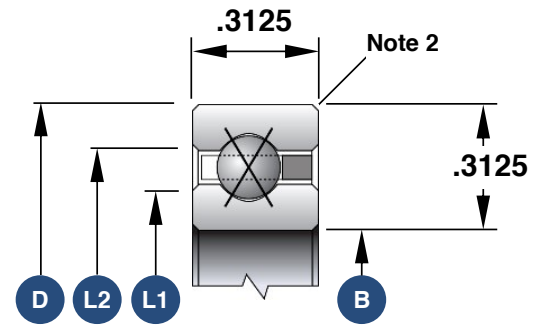

1. Load capacities are not additive
2. The maximum shaft or housing fillet radius that the bearing corners will clear for this series is 0.040"
3. Race Width Tolerance: +0.000 -0.005"

Also Available

Open Angular Contact	SB110AR0
Open Radial Contact	SB110CP0
Open Duplexed (Back-to-Back)	SB110BR0
Open Duplexed (Face-to-Face)	SB110FR0