

SILVERTHIN SB120AR0**12 in Open Type A Thin Section Bearing****Specifications**

Bore (B)	12.000 in
Outside Diameter (D)	12.625 in
Width	5/16"
Land Diameter (L ₁)	12.231 in
Land Diameter (L ₂)	12.393 in
Land Diameter (L ₃)	12.445 in
Approximate Weight	0.83 lbs
Separator	Brass; one piece pocket separator
Precision Class	ABEC Class 1
Bearing Type	Angular Contact (Type A)
Seals, Shields	None (Open)
Unit System	Inch

Load Capacities

Static Radial Load	5,840 lbf
Dynamic Radial Load	1,625 lbf
Static Thrust Load	16,860 lbf
Dynamic Thrust Load	4,240 lbf

Interchange

Silverthin	SB120AR0	Kaydon	KB120AR0
SKF	FPAB1200	FAG	L15RA1200
SSB	RB120AR0	RBC	KB120AR0*RBC

Brass; one piece pocket separator

5/32" balls

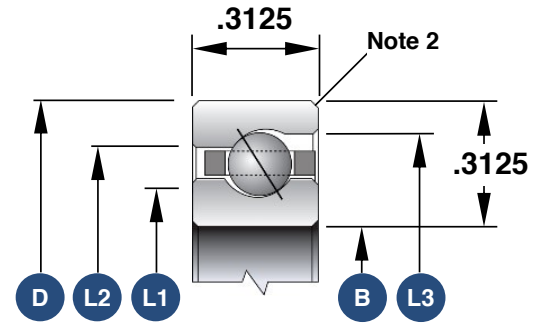

1. Load capacities are not additive
2. The maximum shaft or housing fillet radius that the bearing corners will clear for this series is 0.040"
3. Race Width Tolerance: +0.000 -0.005"

Also Available

Open Radial Contact	SB120CP0
Open 4-Point Contact	SB120XP0
Open Duplexed (Back-to-Back)	SB120BR0
Open Duplexed (Face-to-Face)	SB120FR0