

SILVERTHIN SB120CP0**12 in Open Type C Thin Section Bearing****Specifications**

Bore (B)	12.000 in
Outside Diameter (D)	12.625 in
Width	5/16"
Land Diameter (L ₁)	12.231 in
Land Diameter (L ₂)	12.393 in
Approximate Weight	0.83 lbs
Separator	Brass; snapover separator
Precision Class	ABEC Class 1
Bearing Type	Radial Contact (Type C)
Seals, Shields	None (Open)
Unit System	Inch

Load Capacities

Static Radial Load	5,000 lbf
Dynamic Radial Load	1,540 lbf

Interchange

Silverthin	SB120CP0	Kaydon	KB120CP0	Kaydon	KB120CP0	INA	CSCB120
SKF	FPCB1200	FAG	L10RA1200	NSK	NBC30407	NTN	KRB120
SSB	RB120CP0	RBC	KB120CP0*RBC				

Brass; snapover separator

5/32" balls

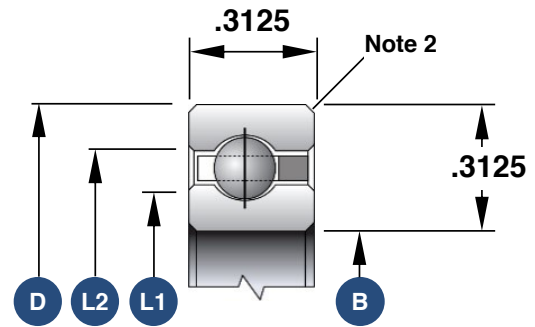

1. Load capacities are not additive
2. The maximum shaft or housing fillet radius that the bearing corners will clear for this series is 0.040"
3. Race Width Tolerance: +0.000 -0.005"

Also Available

Open Angular Contact	SB120AR0
Open 4-Point Contact	SB120XP0
Open Duplexed (Back-to-Back)	SB120BR0
Open Duplexed (Face-to-Face)	SB120FR0