

**SILVERTHIN SB120XP0****12 in Open Type X Thin Section Bearing****Specifications**

|                                 |                           |
|---------------------------------|---------------------------|
| Bore (B)                        | 12.000 in                 |
| Outside Diameter (D)            | 12.625 in                 |
| Width                           | 5/16"                     |
| Land Diameter (L <sub>1</sub> ) | 12.231 in                 |
| Land Diameter (L <sub>2</sub> ) | 12.393 in                 |
| Approximate Weight              | 0.83 lbs                  |
| Separator                       | Brass; snapover separator |
| Precision Class                 | ABEC Class 1              |
| Bearing Type                    | 4-Point Contact (Type X)  |
| Seals, Shields                  | None (Open)               |
| Unit System                     | Inch                      |

**Load Capacities**

|                     |               |
|---------------------|---------------|
| Static Radial Load  | 5,000 lbf     |
| Dynamic Radial Load | 2,045 lbf     |
| Static Thrust Load  | 12,500 lbf    |
| Dynamic Thrust Load | 3,470 lbf     |
| Static Moment Load  | 30,770 in-lbs |
| Dynamic Moment Load | 9,445 in-lbs  |

**Interchange**

|            |                 |        |                     |        |                 |     |                |
|------------|-----------------|--------|---------------------|--------|-----------------|-----|----------------|
| Silverthin | <b>SB120XP0</b> | Kaydon | <b>KB120XP0</b>     | Kaydon | <b>KB120XP0</b> | INA | <b>CSXB120</b> |
| SKF        | <b>FPXB1200</b> | FAG    | <b>L18RA1200</b>    | NSK    | <b>NBX30407</b> | NTN | <b>KXB120</b>  |
| SSB        | <b>RB120XP0</b> | RBC    | <b>KB120XP0*RBC</b> |        |                 |     |                |

**Brass; snapover separator**

5/32" balls

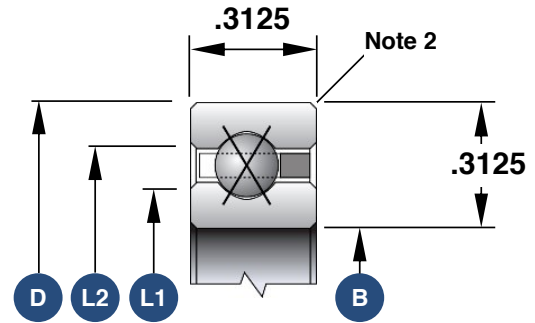

1. Load capacities are not additive
2. The maximum shaft or housing fillet radius that the bearing corners will clear for this series is 0.040"
3. Race Width Tolerance: +0.000 -0.005"

**Also Available**

|                              |                 |
|------------------------------|-----------------|
| Open Angular Contact         | <b>SB120AR0</b> |
| Open Radial Contact          | <b>SB120CP0</b> |
| Open Duplexed (Back-to-Back) | <b>SB120BR0</b> |
| Open Duplexed (Face-to-Face) | <b>SB120FR0</b> |