

SILVERTHIN SB140AR0**14 in Open Type A Thin Section Bearing****Specifications**

Bore (B)	14.000 in
Outside Diameter (D)	14.625 in
Width	5/16"
Land Diameter (L ₁)	14.231 in
Land Diameter (L ₂)	14.393 in
Land Diameter (L ₃)	14.439 in
Approximate Weight	1.05 lbs
Separator	Brass; one piece pocket separator
Precision Class	ABEC Class 1
Bearing Type	Angular Contact (Type A)
Seals, Shields	None (Open)
Unit System	Inch

Load Capacities

Static Radial Load	6,760 lbf
Dynamic Radial Load	1,765 lbf
Static Thrust Load	19,500 lbf
Dynamic Thrust Load	4,670 lbf

Interchange

Silverthin	SB140AR0	Kaydon	KB140AR0
SKF	FPAB1400	FAG	L15RA1400
SSB	RB140AR0	RBC	KB140AR0*RBC

Brass; one piece pocket separator

5/32" balls

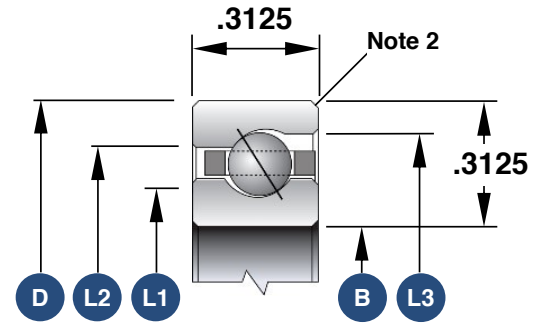

1. Load capacities are not additive
2. The maximum shaft or housing fillet radius that the bearing corners will clear for this series is 0.040"
3. Race Width Tolerance: +0.000 -0.005"

Also Available

Open Radial Contact	SB140CP0
Open 4-Point Contact	SB140XP0
Open Duplexed (Back-to-Back)	SB140BR0
Open Duplexed (Face-to-Face)	SB140FR0