

SILVERTHIN SB140CPO**14 in Open Type C Thin Section Bearing****Specifications**

Bore (B)	14.000 in
Outside Diameter (D)	14.625 in
Width	5/16"
Land Diameter (L ₁)	14.231 in
Land Diameter (L ₂)	14.393 in
Approximate Weight	1.05 lbs
Separator	Brass; snapover separator
Precision Class	ABEC Class 1
Bearing Type	Radial Contact (Type C)
Seals, Shields	None (Open)
Unit System	Inch

Load Capacities

Static Radial Load	5,810 lbf
Dynamic Radial Load	1,680 lbf

Interchange

Silverthin	SB140CPO	Kaydon	KB140CPO	Kaydon	KB140CPO	INA	CSCB140
SKF	FPCB1400	FAG	L10RA1400	NSK	NBC35507	NTN	KRB140
SSB	RB140CPO	RBC	KB140CPO*RBC				

Brass; snapover separator

5/32" balls

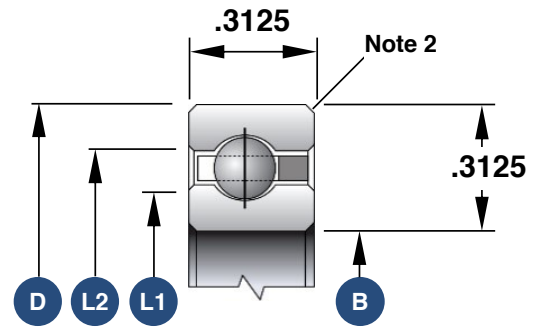

1. Load capacities are not additive
2. The maximum shaft or housing fillet radius that the bearing corners will clear for this series is 0.040"
3. Race Width Tolerance: +0.000 -0.005"

Also Available

Open Angular Contact	SB140AR0
Open 4-Point Contact	SB140XP0
Open Duplexed (Back-to-Back)	SB140BR0
Open Duplexed (Face-to-Face)	SB140FR0