

SILVERTHIN SB140XPO**14 in Open Type X Thin Section Bearing****Specifications**

Bore (B)	14.000 in
Outside Diameter (D)	14.625 in
Width	5/16"
Land Diameter (L ₁)	14.231 in
Land Diameter (L ₂)	14.393 in
Approximate Weight	1.05 lbs
Separator	Brass; snapover separator
Precision Class	ABEC Class 1
Bearing Type	4-Point Contact (Type X)
Seals, Shields	None (Open)
Unit System	Inch

Load Capacities

Static Radial Load	5,810 lbf
Dynamic Radial Load	2,235 lbf
Static Thrust Load	14,530 lbf
Dynamic Thrust Load	3,840 lbf
Static Moment Load	41,580 in-lbs
Dynamic Moment Load	11,995 in-lbs

Interchange

Silverthin	SB140XPO	Kaydon	KB140XPO	Kaydon	KB140XPO	INA	CSXB140
SKF	FPXB1400	FAG	L18RA1400	NSK	NBX35507	NTN	KXB140
SSB	RB140XPO	RBC	KB140XPO*RBC				

Brass; snapover separator

5/32" balls

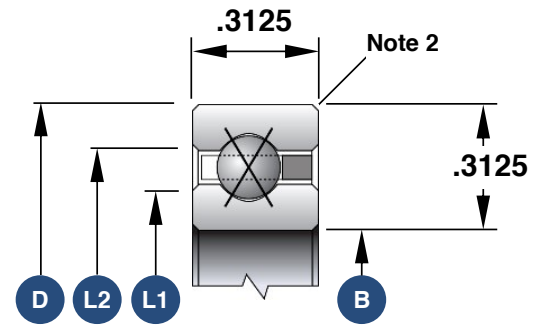

1. Load capacities are not additive
2. The maximum shaft or housing fillet radius that the bearing corners will clear for this series is 0.040"
3. Race Width Tolerance: +0.000 -0.005"

Also Available

Open Angular Contact	SB140ARO
Open Radial Contact	SB140CPO
Open Duplexed (Back-to-Back)	SB140BR0
Open Duplexed (Face-to-Face)	SB140FR0