

**SILVERTHIN SB160AR0****16 in Open Type A Thin Section Bearing****Specifications**

Bore (B)	16.000 in
Outside Diameter (D)	16.625 in
Width	5/16"
Land Diameter (L <sub>1</sub> )	16.231 in
Land Diameter (L <sub>2</sub> )	16.393 in
Land Diameter (L <sub>3</sub> )	16.433 in
Approximate Weight	1.20 lbs
Separator	Brass; one piece pocket separator
Precision Class	ABEC Class 1
Bearing Type	Angular Contact (Type A)
Seals, Shields	None (Open)
Unit System	Inch

**Load Capacities**

Static Radial Load	7,710 lbf
Dynamic Radial Load	1,905 lbf
Static Thrust Load	22,250 lbf
Dynamic Thrust Load	5,100 lbf

**Interchange**

Silverthin	<b>SB160AR0</b>	Kaydon	<b>KB160AR0</b>
SKF	<b>FPAB1600</b>	FAG	<b>L15RA1600</b>
SSB	<b>RB160AR0</b>	RBC	<b>KB160AR0*RBC</b>

**Brass; one piece pocket separator**

5/32" balls

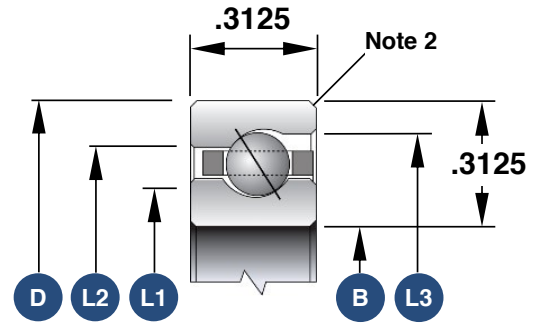

1. Load capacities are not additive
2. The maximum shaft or housing fillet radius that the bearing corners will clear for this series is 0.040"
3. Race Width Tolerance: +0.000 -0.005"

**Also Available**

Open Radial Contact	<b>SB160CP0</b>
Open 4-Point Contact	<b>SB160XP0</b>
Open Duplexed (Back-to-Back)	<b>SB160BR0</b>
Open Duplexed (Face-to-Face)	<b>SB160FR0</b>

Kaydon	<b>KB160AR0</b>	INA	<b>CSEB160</b>
NSK	<b>NBA40607</b>	NTN	<b>KYB160</b>