

SILVERTHIN SB160CP0**16 in Open Type C Thin Section Bearing****Specifications**

Bore (B)	16.000 in
Outside Diameter (D)	16.625 in
Width	5/16"
Land Diameter (L ₁)	16.231 in
Land Diameter (L ₂)	16.393 in
Approximate Weight	1.20 lbs
Separator	Brass; snapover separator
Precision Class	ABEC Class 1
Bearing Type	Radial Contact (Type C)
Seals, Shields	None (Open)
Unit System	Inch

Load Capacities

Static Radial Load	6,620 lbf
Dynamic Radial Load	1,810 lbf

Interchange

Silverthin	SB160CP0	Kaydon	KB160CP0	Kaydon	KB160CP0	INA	CSCB160
SKF	FPCB1600	FAG	L10RA1600	NSK	NBC40607	NTN	KRB160
SSB	RB160CP0	RBC	KB160CP0*RBC				

Brass; snapover separator

5/32" balls

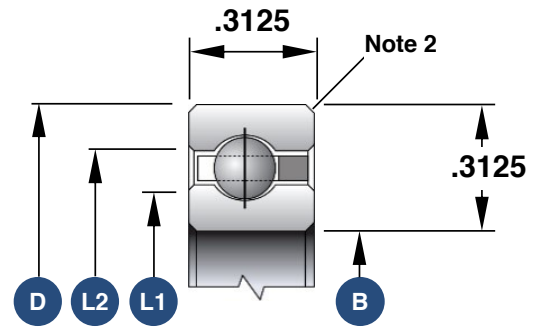

1. Load capacities are not additive
2. The maximum shaft or housing fillet radius that the bearing corners will clear for this series is 0.040"
3. Race Width Tolerance: +0.000 -0.005"

Also Available

Open Angular Contact	SB160AR0
Open 4-Point Contact	SB160XP0
Open Duplexed (Back-to-Back)	SB160BR0
Open Duplexed (Face-to-Face)	SB160FR0