

SILVERTHIN SB160XPO**16 in Open Type X Thin Section Bearing****Specifications**

Bore (B)	16.000 in
Outside Diameter (D)	16.625 in
Width	5/16"
Land Diameter (L ₁)	16.231 in
Land Diameter (L ₂)	16.393 in
Approximate Weight	1.20 lbs
Separator	Brass; snapover separator
Precision Class	ABEC Class 1
Bearing Type	4-Point Contact (Type X)
Seals, Shields	None (Open)
Unit System	Inch

Load Capacities

Static Radial Load	6,620 lbf
Dynamic Radial Load	2,410 lbf
Static Thrust Load	16,560 lbf
Dynamic Thrust Load	4,190 lbf
Static Moment Load	54,020 in-lbs
Dynamic Moment Load	14,750 in-lbs

Interchange

Silverthin	SB160XPO	Kaydon	KB160XPO	Kaydon	KB160XPO	INA	CSXB160
SKF	FPXB1600	FAG	L18RA1600	NSK	NBX40607	NTN	KXB160
SSB	RB160XPO	RBC	KB160XPO*RBC				

Brass; snapover separator

5/32" balls

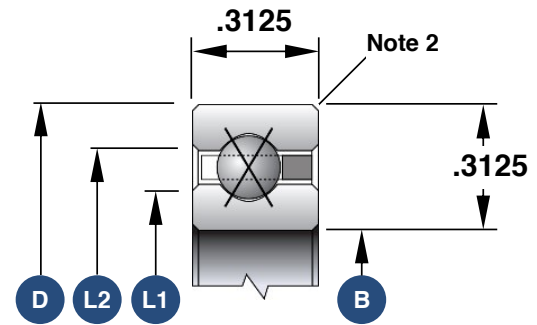

1. Load capacities are not additive
2. The maximum shaft or housing fillet radius that the bearing corners will clear for this series is 0.040"
3. Race Width Tolerance: +0.000 -0.005"

Also Available

Open Angular Contact	SB160ARO
Open Radial Contact	SB160CPO
Open Duplexed (Back-to-Back)	SB160BR0
Open Duplexed (Face-to-Face)	SB160FR0