

SILVERTHIN SB180AR0**18 in Open Type A Thin Section Bearing****Specifications**

Bore (B)	18.000 in
Outside Diameter (D)	18.625 in
Width	5/16"
Land Diameter (L ₁)	18.231 in
Land Diameter (L ₂)	18.393 in
Land Diameter (L ₃)	18.425 in
Approximate Weight	1.35 lbs
Separator	Brass; one piece pocket separator
Precision Class	ABEC Class 1
Bearing Type	Angular Contact (Type A)
Seals, Shields	None (Open)
Unit System	Inch

Load Capacities

Static Radial Load	8,660 lbf
Dynamic Radial Load	2,040 lbf
Static Thrust Load	24,990 lbf
Dynamic Thrust Load	5,510 lbf

Interchange

Silverthin	SB180AR0	Kaydon	KB180AR0
SKF	FPAB1800	FAG	L15RA1800
SSB	RB180AR0	RBC	KB180AR0*RBC

Brass; one piece pocket separator

5/32" balls

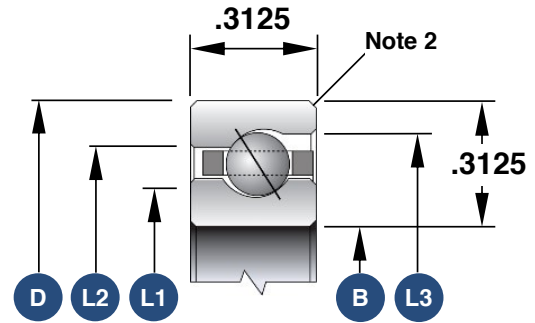

1. Load capacities are not additive
2. The maximum shaft or housing fillet radius that the bearing corners will clear for this series is 0.040"
3. Race Width Tolerance: +0.000 -0.005"

Also Available

Open Radial Contact	SB180CP0
Open 4-Point Contact	SB180XP0
Open Duplexed (Back-to-Back)	SB180BR0
Open Duplexed (Face-to-Face)	SB180FR0