

SILVERTHIN SB180XPO**18 in Open Type X Thin Section Bearing****Specifications**

Bore (B)	18.000 in
Outside Diameter (D)	18.625 in
Width	5/16"
Land Diameter (L ₁)	18.231 in
Land Diameter (L ₂)	18.393 in
Approximate Weight	1.35 lbs
Separator	Brass; snapover separator
Precision Class	ABEC Class 1
Bearing Type	4-Point Contact (Type X)
Seals, Shields	None (Open)
Unit System	Inch

Load Capacities

Static Radial Load	7,440 lbf
Dynamic Radial Load	2,575 lbf
Static Thrust Load	18,590 lbf
Dynamic Thrust Load	4,520 lbf
Static Moment Load	68,090 in-lbs
Dynamic Moment Load	17,695 in-lbs

Interchange

Silverthin	SB180XPO	Kaydon	KB180XPO	Kaydon	KB180XPO	INA	CSXB180
SKF	FPXB1800	FAG	L18RA1800	NSK	NBX45707	NTN	KXB180
SSB	RB180XPO	RBC	KB180XPO*RBC				

Brass; snapover separator

5/32" balls

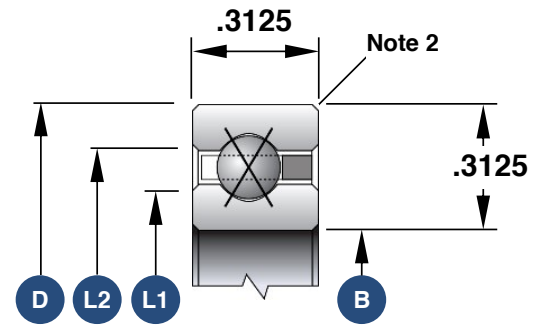

1. Load capacities are not additive
2. The maximum shaft or housing fillet radius that the bearing corners will clear for this series is 0.040"
3. Race Width Tolerance: +0.000 -0.005"

Also Available

Open Angular Contact	SB180ARO
Open Radial Contact	SB180CPO
Open Duplexed (Back-to-Back)	SB180BR0
Open Duplexed (Face-to-Face)	SB180FR0