

SILVERTHIN SB200AR0**20 in Open Type A Thin Section Bearing****Specifications**

Bore (B)	20.000 in
Outside Diameter (D)	20.625 in
Width	5/16"
Land Diameter (L ₁)	20.231 in
Land Diameter (L ₂)	20.393 in
Land Diameter (L ₃)	20.416 in
Approximate Weight	1.50 lbs
Separator	Brass; one piece pocket separator
Precision Class	ABEC Class 1
Bearing Type	Angular Contact (Type A)
Seals, Shields	None (Open)
Unit System	Inch

Load Capacities

Static Radial Load	9,610 lbf
Dynamic Radial Load	2,160 lbf
Static Thrust Load	27,730 lbf
Dynamic Thrust Load	5,900 lbf

Interchange

Silverthin	SB200AR0	Kaydon	KB200AR0
SKF	FPAB2000	FAG	L15RA2000
SSB	RB200AR0	RBC	KB200AR0*RBC

Brass; one piece pocket separator

5/32" balls

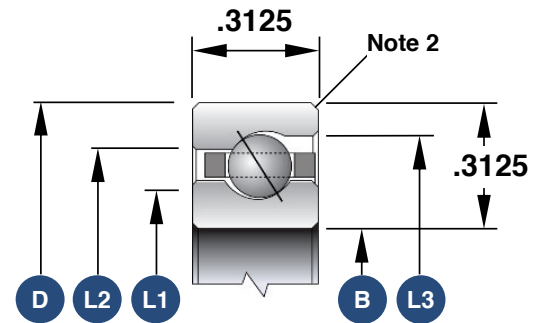

1. Load capacities are not additive
2. The maximum shaft or housing fillet radius that the bearing corners will clear for this series is 0.040"
3. Race Width Tolerance: +0.000 -0.005"

Also Available

Open Radial Contact	SB200CP0
Open 4-Point Contact	SB200XP0
Open Duplexed (Back-to-Back)	SB200BR0
Open Duplexed (Face-to-Face)	SB200FR0