

SILVERTHIN SB200CPO**20 in Open Type C Thin Section Bearing****Specifications**

Bore (B)	20.000 in
Outside Diameter (D)	20.625 in
Width	5/16"
Land Diameter (L ₁)	20.231 in
Land Diameter (L ₂)	20.393 in
Approximate Weight	1.50 lbs
Separator	Brass; snapover separator
Precision Class	ABEC Class 1
Bearing Type	Radial Contact (Type C)
Seals, Shields	None (Open)
Unit System	Inch

Load Capacities

Static Radial Load	8,250 lbf
Dynamic Radial Load	2,055 lbf

Interchange

Silverthin	SB200CPO	Kaydon	KB200CPO	Kaydon	KB200CPO	INA	CSCB200
SKF	FPCB2000	FAG	L10RA2000	NSK	NBC50807	NTN	KRB200
SSB	RB200CPO	RBC	KB200CPO*RBC				

Brass; snapover separator

5/32" balls

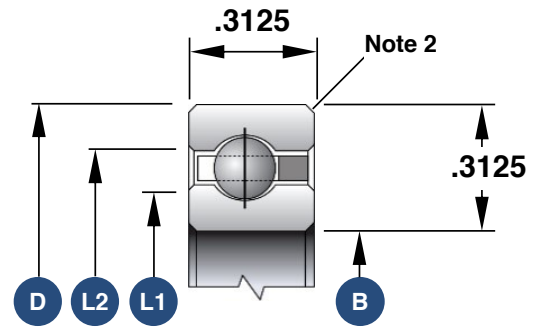

1. Load capacities are not additive
2. The maximum shaft or housing fillet radius that the bearing corners will clear for this series is 0.040"
3. Race Width Tolerance: +0.000 -0.005"

Also Available

Open Angular Contact	SB200ARO
Open 4-Point Contact	SB200XPO
Open Duplexed (Back-to-Back)	SB200BR0
Open Duplexed (Face-to-Face)	SB200FR0