

SILVERTHIN SB200XPO**20 in Open Type X Thin Section Bearing****Specifications**

Bore (B)	20.000 in
Outside Diameter (D)	20.625 in
Width	5/16"
Land Diameter (L ₁)	20.231 in
Land Diameter (L ₂)	20.393 in
Approximate Weight	1.50 lbs
Separator	Brass; snapover separator
Precision Class	ABEC Class 1
Bearing Type	4-Point Contact (Type X)
Seals, Shields	None (Open)
Unit System	Inch

Load Capacities

Static Radial Load	8,250 lbf
Dynamic Radial Load	2,730 lbf
Static Thrust Load	20,620 lbf
Dynamic Thrust Load	4,850 lbf
Static Moment Load	83,780 in-lbs
Dynamic Moment Load	20,815 in-lbs

Interchange

Silverthin	SB200XPO	Kaydon	KB200XPO	Kaydon	KB200XPO	INA	CSXB200
SKF	FPXB2000	FAG	L18RA2000	NSK	NBX50807	NTN	KXB200
SSB	RB200XPO	RBC	KB200XPO*RBC				

Brass; snapover separator

5/32" balls

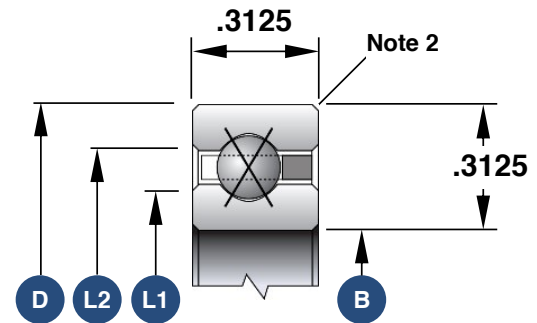

1. Load capacities are not additive
2. The maximum shaft or housing fillet radius that the bearing corners will clear for this series is 0.040"
3. Race Width Tolerance: +0.000 -0.005"

Also Available

Open Angular Contact	SB200ARO
Open Radial Contact	SB200CPO
Open Duplexed (Back-to-Back)	SB200BR0
Open Duplexed (Face-to-Face)	SB200FR0