

SILVERTHIN SC042CP0**4.25 in Open Type C Thin Section Bearing****Specifications**

Bore (B)	4.250 in
Outside Diameter (D)	5.000 in
Width	3/8"
Land Diameter (L ₁)	4.527 in
Land Diameter (L ₂)	4.723 in
Approximate Weight	0.19 lbs
Separator	Brass; snapover separator
Precision Class	ABEC Class 1
Bearing Type	Radial Contact (Type C)
Seals, Shields	None (Open)
Unit System	Inch

Load Capacities

Static Radial Load	2,220 lbf
Dynamic Radial Load	1,110 lbf

Interchange

Silverthin	SC042CP0	Kaydon	KC042CP0	Kaydon	KC042CP0	INA	CSCC042
SKF	FPCC404	FAG	L10SA404	NSK	NBC10709	NTN	KRC042
SSB	RC042CP0	RBC	KC042CP0*RBC				

Brass; snapover separator

3/16" balls

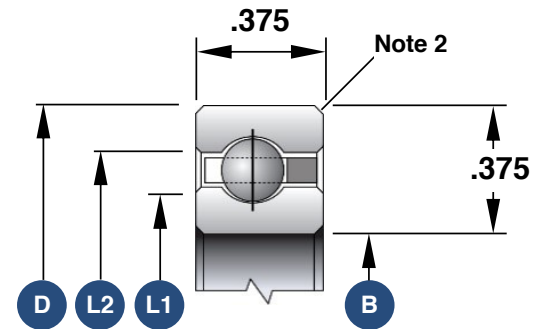

1. Load capacities are not additive
2. The maximum shaft or housing fillet radius that the bearing corners will clear for this series is 0.040"
3. Race Width Tolerance: +0.000 -0.005"

Also Available

Open Angular Contact	SC042AR0
Open 4-Point Contact	SC042XP0
Sealed Radial Contact	JSU042CP0
Sealed 4-Point Contact	JSU042XP0
Open Duplexed (Back-to-Back)	SC042BR0
Open Duplexed (Face-to-Face)	SC042FR0