

SILVERTHIN SC060AR0**6 in Open Type A Thin Section Bearing****Specifications**

Bore (B)	6.000 in
Outside Diameter (D)	6.750 in
Width	3/8"
Land Diameter (L ₁)	6.277 in
Land Diameter (L ₂)	6.473 in
Land Diameter (L ₃)	6.550 in
Approximate Weight	0.63 lbs
Separator	Brass; one piece pocket separator
Precision Class	ABEC Class 1
Bearing Type	Angular Contact (Type A)
Seals, Shields	None (Open)
Unit System	Inch

Load Capacities

Static Radial Load	3,750 lbf
Dynamic Radial Load	1,450 lbf
Static Thrust Load	10,820 lbf
Dynamic Thrust Load	3,580 lbf

Interchange

Silverthin	SC060AR0	Kaydon	KC060AR0	Kaydon	KC060AR0	INA	CSEC060
SKF	FPAC600	FAG	L15SA600	NSK	NBA15209	NTN	KYC060
SSB	RC060AR0	RBC	KC060AR0*RBC				

Brass; one piece pocket separator

3/16" balls

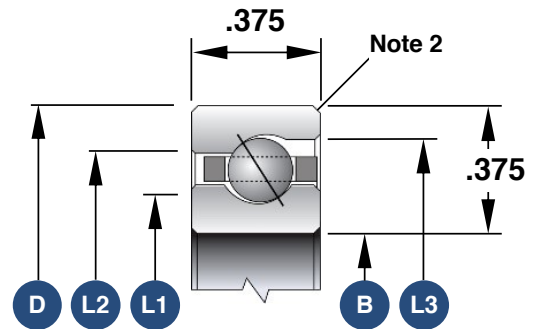

1. Load capacities are not additive
2. The maximum shaft or housing fillet radius that the bearing corners will clear for this series is 0.040"
3. Race Width Tolerance: +0.000 -0.005"

Also Available

Open Radial Contact	SC060CP0
Open 4-Point Contact	SC060XP0
Sealed Radial Contact	JSU060CP0
Sealed 4-Point Contact	JSU060XP0
Open Duplexed (Back-to-Back)	SC060BR0
Open Duplexed (Face-to-Face)	SC060FR0