

SILVERTHIN SC065AR0**6.5 in Open Type A Thin Section Bearing****Specifications**

Bore (B)	6.500 in
Outside Diameter (D)	7.250 in
Width	3/8"
Land Diameter (L ₁)	6.777 in
Land Diameter (L ₂)	6.973 in
Land Diameter (L ₃)	7.050 in
Approximate Weight	0.68 lbs
Separator	Brass; one piece pocket separator
Precision Class	ABEC Class 1
Bearing Type	Angular Contact (Type A)
Seals, Shields	None (Open)
Unit System	Inch

Load Capacities

Static Radial Load	4,060 lbf
Dynamic Radial Load	1,520 lbf
Static Thrust Load	11,720 lbf
Dynamic Thrust Load	3,770 lbf

Interchange

Silverthin	SC065AR0	Kaydon	KC065AR0	Kaydon	KC065AR0	INA	CSEC065
SKF	FPAC608	FAG	L15SA608	NSK	NBA16509	NTN	KYC065
SSB	RC065AR0	RBC	KC065AR0*RBC				

Brass; one piece pocket separator

3/16" balls

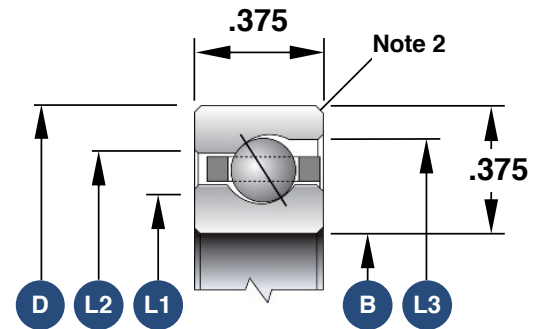

1. Load capacities are not additive
2. The maximum shaft or housing fillet radius that the bearing corners will clear for this series is 0.040"
3. Race Width Tolerance: +0.000 -0.005"

Also Available

Open Radial Contact	SC065CP0
Open 4-Point Contact	SC065XP0
Sealed Radial Contact	JSU065CP0
Sealed 4-Point Contact	JSU065XP0
Open Duplexed (Back-to-Back)	SC065BR0
Open Duplexed (Face-to-Face)	SC065FR0