

SILVERTHIN SC090AR0**9 in Open Type A Thin Section Bearing****Specifications**

| | |
|---------------------------------|-----------------------------------|
| Bore (B) | 9.000 in |
| Outside Diameter (D) | 9.750 in |
| Width | 3/8" |
| Land Diameter (L ₁) | 9.277 in |
| Land Diameter (L ₂) | 9.473 in |
| Land Diameter (L ₃) | 9.546 in |
| Approximate Weight | 0.94 lbs |
| Separator | Brass; one piece pocket separator |
| Precision Class | ABEC Class 1 |
| Bearing Type | Angular Contact (Type A) |
| Seals, Shields | None (Open) |
| Unit System | Inch |

Load Capacities

| | |
|---------------------|------------|
| Static Radial Load | 5,520 lbf |
| Dynamic Radial Load | 1,820 lbf |
| Static Thrust Load | 15,930 lbf |
| Dynamic Thrust Load | 4,630 lbf |

Interchange

| | | | | | | | |
|------------|--------------------------|--------|------------------------------|--------|--------------------------|-----|-------------------------|
| Silverthin | SC090AR0 | Kaydon | KC090AR0 | Kaydon | KC090AR0 | INA | CSEC090 |
| SKF | FPAC900 | FAG | L15SA900 | NSK | NBA22809 | NTN | KYC090 |
| SSB | RC090AR0 | RBC | KC090AR0*RBC | | | | |

Brass; one piece pocket separator

3/16" balls

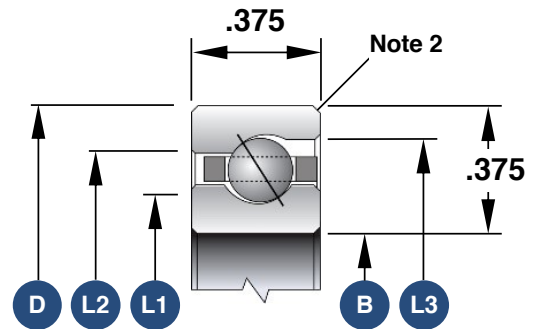

1. Load capacities are not additive
2. The maximum shaft or housing fillet radius that the bearing corners will clear for this series is 0.040"
3. Race Width Tolerance: +0.000 -0.005"

Also Available

| | |
|------------------------------|---------------------------|
| Open Radial Contact | SC090CP0 |
| Open 4-Point Contact | SC090XP0 |
| Sealed Radial Contact | JSU090CP0 |
| Sealed 4-Point Contact | JSU090XP0 |
| Open Duplexed (Back-to-Back) | SC090BR0 |
| Open Duplexed (Face-to-Face) | SC090FR0 |