

**SILVERTHIN SD040XP0****4 in Open Type X Thin Section Bearing****Specifications**

Bore (B)	4.000 in
Outside Diameter (D)	5.000 in
Width	1/2"
Land Diameter (L <sub>1</sub> )	4.370 in
Land Diameter (L <sub>2</sub> )	4.630 in
Approximate Weight	0.78 lbs
Separator	Brass; snapover separator
Precision Class	ABEC Class 1
Bearing Type	4-Point Contact (Type X)
Seals, Shields	None (Open)
Unit System	Inch

**Load Capacities**

Static Radial Load	3,080 lbf
Dynamic Radial Load	2,310 lbf
Static Thrust Load	7,700 lbf
Dynamic Thrust Load	3,520 lbf
Static Moment Load	6,930 in-lbs
Dynamic Moment Load	3,900 in-lbs

**Interchange**

Silverthin	<a href="#">SD040XP0</a>	Kaydon	<a href="#">KD040XP0</a>	Kaydon	<a href="#">KD040XP0</a>	INA	<a href="#">CSXD040</a>
SKF	<a href="#">FPXD400</a>	FAG	<a href="#">L18TA400</a>	NSK	<a href="#">NBX10112</a>	NTN	<a href="#">KXD040</a>
SSB	<a href="#">RD040XP0</a>	RBC	<a href="#">KD040XP0*RBC</a>				

**Brass; snapover separator**

1/4" balls

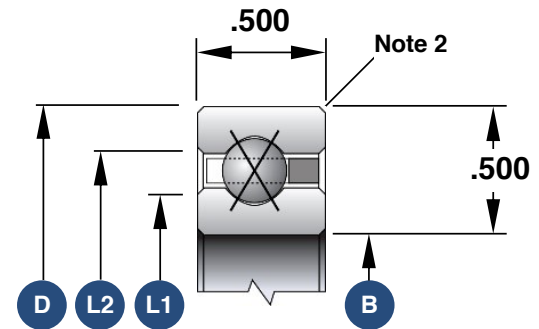

1. Load capacities are not additive
2. The maximum shaft or housing fillet radius that the bearing corners will clear for this series is 0.060"
3. Race Width Tolerance: +0.000 -0.005"

**Also Available**

Open Angular Contact	<a href="#">SD040ARO</a>
Open Radial Contact	<a href="#">SD040CPO</a>
Open Duplexed (Back-to-Back)	<a href="#">SD040BR0</a>
Open Duplexed (Face-to-Face)	<a href="#">SD040FR0</a>