

SILVERTHIN SD042AR0**4.25 in Open Type A Thin Section Bearing****Specifications**

Bore (B)	4.250 in
Outside Diameter (D)	5.250 in
Width	1/2"
Land Diameter (L ₁)	4.620 in
Land Diameter (L ₂)	4.880 in
Land Diameter (L ₃)	4.991 in
Approximate Weight	0.83 lbs
Separator	Brass; one piece pocket separator
Precision Class	ABEC Class 1
Bearing Type	Angular Contact (Type A)
Seals, Shields	None (Open)
Unit System	Inch

Load Capacities

Static Radial Load	3,750 lbf
Dynamic Radial Load	1,875 lbf
Static Thrust Load	10,830 lbf
Dynamic Thrust Load	4,420 lbf

Interchange

Silverthin	SD042AR0	Kaydon	KD042AR0
SKF	FPAD404	FAG	L15TA404
SSB	RD042AR0	RBC	KD042AR0*RBC

Brass; one piece pocket separator

1/4" balls

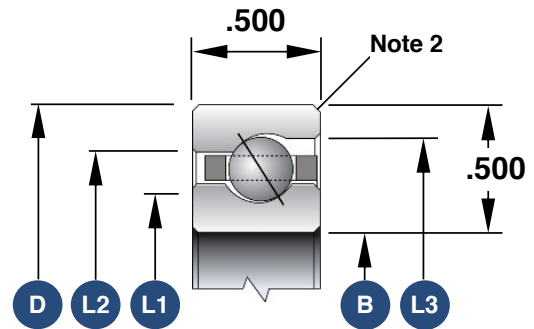

1. Load capacities are not additive
2. The maximum shaft or housing fillet radius that the bearing corners will clear for this series is 0.060"
3. Race Width Tolerance: +0.000 -0.005"

Also Available

Open Radial Contact	SD042CP0
Open 4-Point Contact	SD042XP0
Open Duplexed (Back-to-Back)	SD042BR0
Open Duplexed (Face-to-Face)	SD042FR0