

SILVERTHIN SD042CP0**4.25 in Open Type C Thin Section Bearing****Specifications**

Bore (B)	4.250 in
Outside Diameter (D)	5.250 in
Width	1/2"
Land Diameter (L ₁)	4.620 in
Land Diameter (L ₂)	4.880 in
Approximate Weight	0.83 lbs
Separator	Brass; snapover separator
Precision Class	ABEC Class 1
Bearing Type	Radial Contact (Type C)
Seals, Shields	None (Open)
Unit System	Inch

Load Capacities

Static Radial Load	3,191 lbf
Dynamic Radial Load	1,785 lbf

Interchange

Silverthin	SD042CP0	Kaydon	KD042CP0	Kaydon	KD042CP0	INA	CSCD042
SKF	FPCD420	FAG	L10TA404	NSK	NBC10712	NTN	KRD042
SSB	RD042CP0	RBC	KD042CP0*RBC				

Brass; snapover separator

1/4" balls

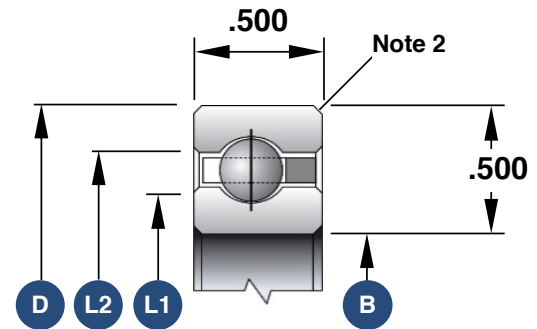

1. Load capacities are not additive
2. The maximum shaft or housing fillet radius that the bearing corners will clear for this series is 0.060"
3. Race Width Tolerance: +0.000 -0.005"

Also Available

Open Angular Contact	SD042AR0
Open 4-Point Contact	SD042XP0
Open Duplexed (Back-to-Back)	SD042BR0
Open Duplexed (Face-to-Face)	SD042FR0