

SILVERTHIN SD042XPO**4.25 in Open Type X Thin Section Bearing****Specifications**

Bore (B)	4.250 in
Outside Diameter (D)	5.250 in
Width	1/2"
Land Diameter (L ₁)	4.620 in
Land Diameter (L ₂)	4.880 in
Approximate Weight	0.83 lbs
Separator	Brass; snapover separator
Precision Class	ABEC Class 1
Bearing Type	4-Point Contact (Type X)
Seals, Shields	None (Open)
Unit System	Inch

Load Capacities

Static Radial Load	3,190 lbf
Dynamic Radial Load	2,355 lbf
Static Thrust Load	7,980 lbf
Dynamic Thrust Load	3,600 lbf
Static Moment Load	7,580 in-lbs
Dynamic Moment Load	4,195 in-lbs

Interchange

Silverthin	SD042XPO	Kaydon	KD042XPO	Kaydon	KD042XPO	INA	CSXD042
SKF	FPXD404	FAG	L18TA404	NSK	NBX10712	NTN	KXD042
SSB	RD042XPO	RBC	KD042XPO*RBC				

Brass; snapover separator

1/4" balls

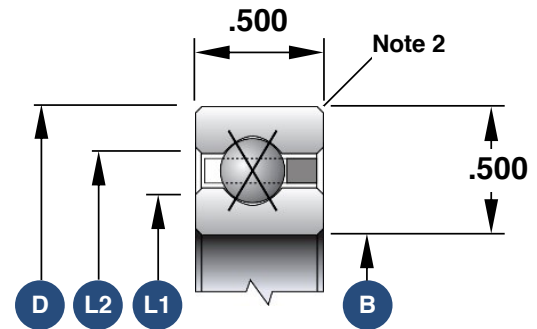

1. Load capacities are not additive
2. The maximum shaft or housing fillet radius that the bearing corners will clear for this series is 0.060"
3. Race Width Tolerance: +0.000 -0.005"

Also Available

Open Angular Contact	SD042AR0
Open Radial Contact	SD042CP0
Open Duplexed (Back-to-Back)	SD042BR0
Open Duplexed (Face-to-Face)	SD042FR0