

SILVERTHIN SD045ARO**4.5 in Open Type A Thin Section Bearing****Specifications**

Bore (B)	4.500 in
Outside Diameter (D)	5.500 in
Width	1/2"
Land Diameter (L ₁)	4.870 in
Land Diameter (L ₂)	5.130 in
Land Diameter (L ₃)	5.241 in
Approximate Weight	0.88 lbs
Separator	Brass; one piece pocket separator
Precision Class	ABEC Class 1
Bearing Type	Angular Contact (Type A)
Seals, Shields	None (Open)
Unit System	Inch

Load Capacities

Static Radial Load	3,950 lbf
Dynamic Radial Load	1,930 lbf
Static Thrust Load	11,400 lbf
Dynamic Thrust Load	4,570 lbf

Interchange

Silverthin	SD045ARO	Kaydon	KD045ARO
SKF	FPAD408	FAG	L15TA408
SSB	RD045ARO	RBC	KD045ARO*RBC

Brass; one piece pocket separator

1/4" balls

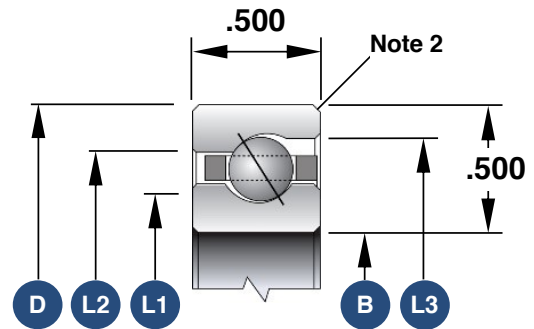

1. Load capacities are not additive
2. The maximum shaft or housing fillet radius that the bearing corners will clear for this series is 0.060"
3. Race Width Tolerance: +0.000 -0.005"

Also Available

Open Radial Contact	SD045CP0
Open 4-Point Contact	SD045XP0
Open Duplexed (Back-to-Back)	SD045BR0
Open Duplexed (Face-to-Face)	SD045FR0