

SILVERTHIN SD045CP0**4.5 in Open Type C Thin Section Bearing****Specifications**

Bore (B)	4.500 in
Outside Diameter (D)	5.500 in
Width	1/2"
Land Diameter (L ₁)	4.870 in
Land Diameter (L ₂)	5.130 in
Approximate Weight	0.88 lbs
Separator	Brass; snapover separator
Precision Class	ABEC Class 1
Bearing Type	Radial Contact (Type C)
Seals, Shields	None (Open)
Unit System	Inch

Load Capacities

Static Radial Load	3,421 lbf
Dynamic Radial Load	1,860 lbf

Interchange

Silverthin	SD045CP0	Kaydon	KD045CP0	Kaydon	KD045CP0	INA	CSCD045
SKF	FPCD408	FAG	L10TA408	NSK	NBC11412	NTN	KRD045
SSB	RD045CP0	RBC	KD045CP0*RBC				

Brass; snapover separator

1/4" balls

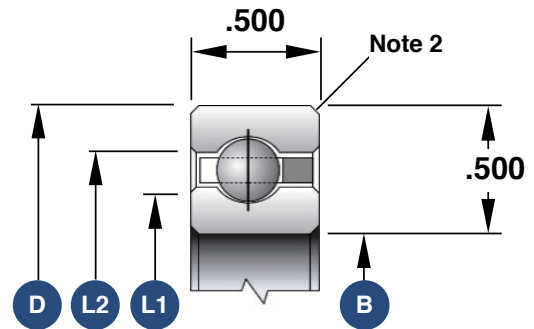

1. Load capacities are not additive
2. The maximum shaft or housing fillet radius that the bearing corners will clear for this series is 0.060"
3. Race Width Tolerance: +0.000 -0.005"

Also Available

Open Angular Contact	SD045AR0
Open 4-Point Contact	SD045XP0
Open Duplexed (Back-to-Back)	SD045BR0
Open Duplexed (Face-to-Face)	SD045FR0