

**SILVERTHIN SD045XP0****4.5 in Open Type X Thin Section Bearing****Specifications**

Bore (B)	4.500 in
Outside Diameter (D)	5.500 in
Width	1/2"
Land Diameter (L <sub>1</sub> )	4.870 in
Land Diameter (L <sub>2</sub> )	5.130 in
Approximate Weight	0.88 lbs
Separator	Brass; snapover separator
Precision Class	ABEC Class 1
Bearing Type	4-Point Contact (Type X)
Seals, Shields	None (Open)
Unit System	Inch

**Load Capacities**

Static Radial Load	3,420 lbf
Dynamic Radial Load	2,455 lbf
Static Thrust Load	8,550 lbf
Dynamic Thrust Load	3,770 lbf
Static Moment Load	8,550 in-lbs
Dynamic Moment Load	4,600 in-lbs

**Interchange**

Silverthin	<a href="#">SD045XP0</a>	Kaydon	<a href="#">KD045XP0</a>	Kaydon	<a href="#">KD045XP0</a>	INA	<a href="#">CSXD045</a>
SKF	<a href="#">FPXD408</a>	FAG	<a href="#">L18TA408</a>	NSK	<a href="#">NBX11412</a>	NTN	<a href="#">KXD045</a>
SSB	<a href="#">RD045XP0</a>	RBC	<a href="#">KD045XP0*RBC</a>				

**Brass; snapover separator**

1/4" balls

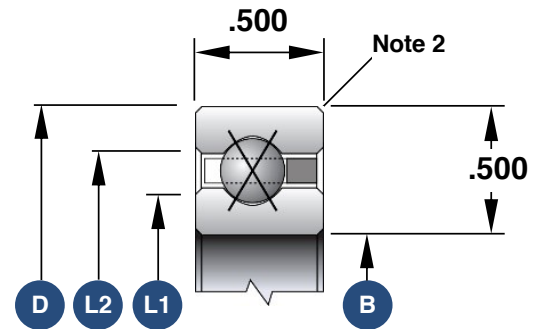

1. Load capacities are not additive
2. The maximum shaft or housing fillet radius that the bearing corners will clear for this series is 0.060"
3. Race Width Tolerance: +0.000 -0.005"

**Also Available**

Open Angular Contact	<a href="#">SD045AR0</a>
Open Radial Contact	<a href="#">SD045CP0</a>
Open Duplexed (Back-to-Back)	<a href="#">SD045BR0</a>
Open Duplexed (Face-to-Face)	<a href="#">SD045FR0</a>