

SILVERTHIN SD047AR0**4.75 in Open Type A Thin Section Bearing****Specifications**

Bore (B)	4.750 in
Outside Diameter (D)	5.750 in
Width	1/2"
Land Diameter (L ₁)	5.120 in
Land Diameter (L ₂)	5.380 in
Land Diameter (L ₃)	5.490 in
Approximate Weight	0.94 lbs
Separator	Brass; one piece pocket separator
Precision Class	ABEC Class 1
Bearing Type	Angular Contact (Type A)
Seals, Shields	None (Open)
Unit System	Inch

Load Capacities

Static Radial Load	4,150 lbf
Dynamic Radial Load	1,985 lbf
Static Thrust Load	11,970 lbf
Dynamic Thrust Load	4,720 lbf

Interchange

Silverthin	SD047AR0	Kaydon	KD047AR0
SKF	FPAD412	FAG	L15TA412
SSB	RD047AR0	RBC	KD047AR0*RBC

Brass; one piece pocket separator

1/4" balls

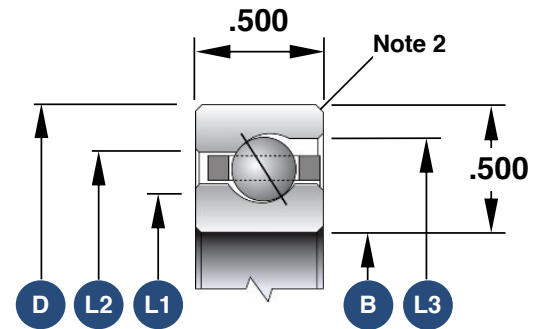

1. Load capacities are not additive
2. The maximum shaft or housing fillet radius that the bearing corners will clear for this series is 0.060"
3. Race Width Tolerance: +0.000 -0.005"

Also Available

Open Radial Contact	SD047CP0
Open 4-Point Contact	SD047XP0
Open Duplexed (Back-to-Back)	SD047BR0
Open Duplexed (Face-to-Face)	SD047FR0